

TECHNICAL AREA (TA) 55

**EXPLANATION OF PROCESS CODE LISTINGS
AND DESIGN CAPACITIES AT TECHNICAL AREA (TA) 55**

Description	Capacity (gallons)	Associated Structure No./Area	Co-Operator
<u>Item 6, Line 20 S01 Container Storage Units</u>			
Container storage unit (B40) for RCRA ¹ -regulated waste	21,500	TA-55-4, Basement	DOE/Triad
Container storage unit (B05) for RCRA ¹ -regulated waste	3,600	TA-55-4, Basement	DOE/Triad
Container storage unit (K13) for RCRA ¹ -regulated waste	2,500	TA-55-4, Basement	DOE/Triad
Container storage unit (B45) for RCRA ¹ -regulated waste	11,000	TA-55-4, Basement	DOE/Triad
Container storage unit (Vault) for RCRA ¹ -regulated waste	4,000	TA-55-4, Basement	DOE/Triad
Outdoor Pad for RCRA ¹ -regulated waste	135,000	Near TA-55-4	DOE/Triad
Container storage unit (TA-55-0355 Pad) RCRA ¹ -regulated waste	84,370	Near TA-55-185	DOE/Triad
Container storage unit (B13) for RCRA ¹ -regulated waste	4,950	TA-55-4, Basement	DOE/Triad
Container storage unit (G12) for RCRA ¹ -regulated waste	5,225	TA-55-4, Basement	DOE/Triad
TOTAL S01	272,145		

¹ RCRA is the Resource Conservation and Recovery Act.

**EXPLANATION OF PROCESS CODE LISTINGS
 AND DESIGN CAPACITIES AT TECHNICAL AREA (TA) 55
 (Continued)**

Description	Capacity (gallons)	Associated Structure No./Area	Co-Operator
<u>Item 6, Line 21 S02 Tank Storage System</u>			
Storage tank system for RCRA ¹ -regulated waste (evaporator glovebox storage tank component; cementation unit storage tank component)	137 ²	TA-55-4, Room 401	DOE/Triad
TOTAL S02	137		

¹ RCRA is the Resource Conservation and Recovery Act.

² Total combined capacity for both storage tank components.

**EXPLANATION OF PROCESS CODE LISTINGS
AND DESIGN CAPACITIES AT TECHNICAL AREA (TA) 55
(Continued)**

Description	Capacity (gallons per day)	Associated Structure No./Area	Co-Operator
<u>Item 6, Line 22 T04 Treatment - Other</u>			
Stabilization unit for RCRA ¹ regulated waste	150	TA-55-4, Room 401	DOE/Triad
Macroencapsulation process for RCRA ¹ - regulated waste	13,764	Within container storage units TA-55-4, Rooms B40, B45; TA-55-4 Outdoor Pad; and TA- 55-355 Pad	DOE/Triad
TOTAL T04	13, 914		

¹ RCRA is the Resource Conservation and Recovery Act.

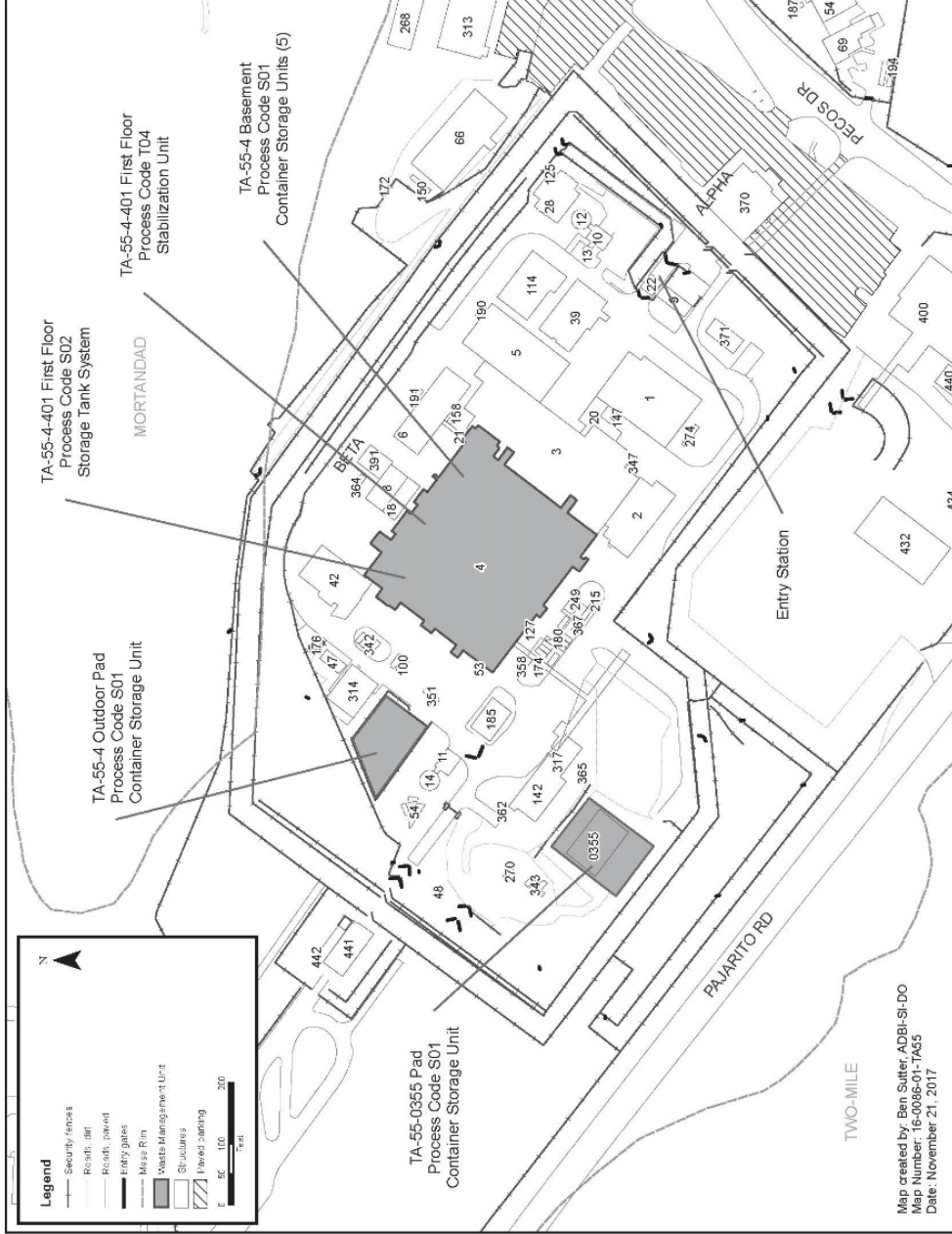

Figure 55-1
 Technical Area (TA) 55, Site Location Map

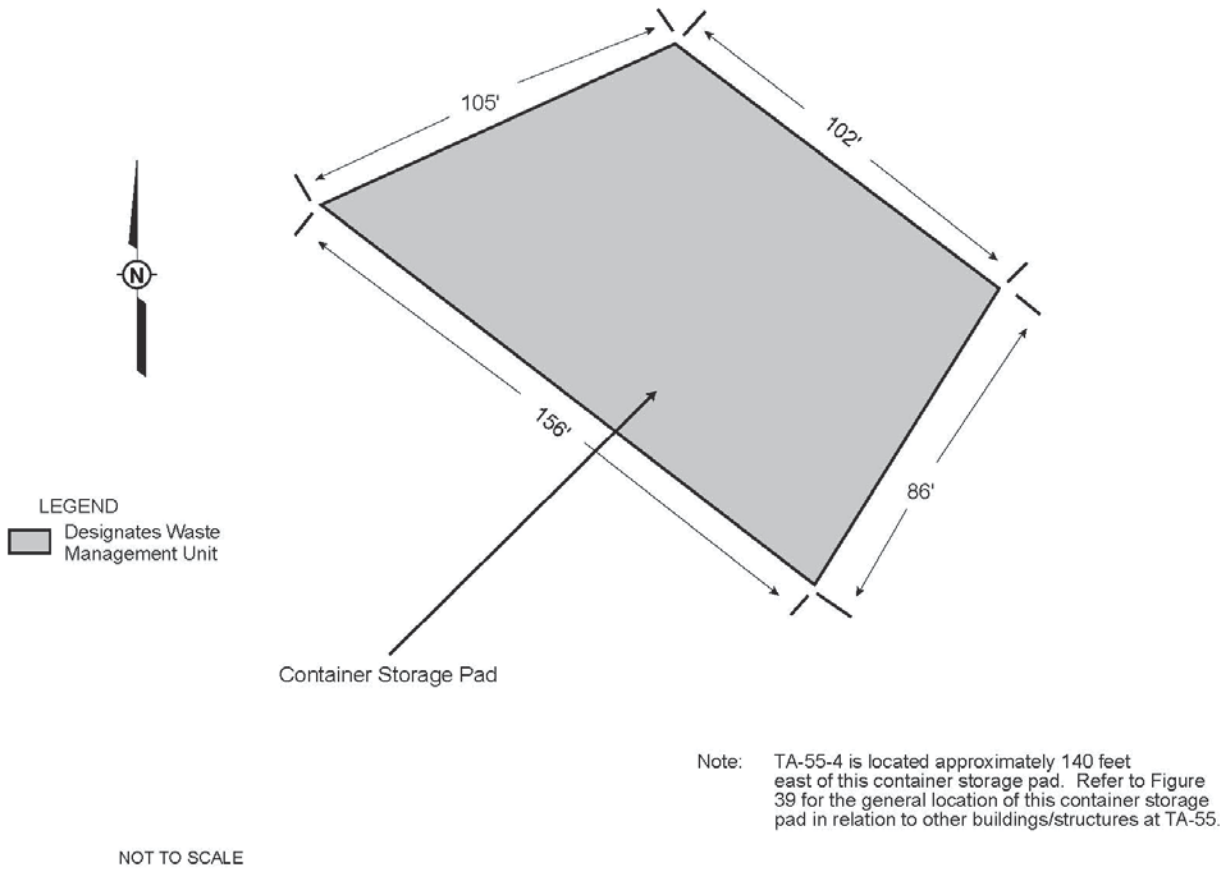

Figure 55-2
Technical Area (TA) 55 Outdoor Pad West of Building 4

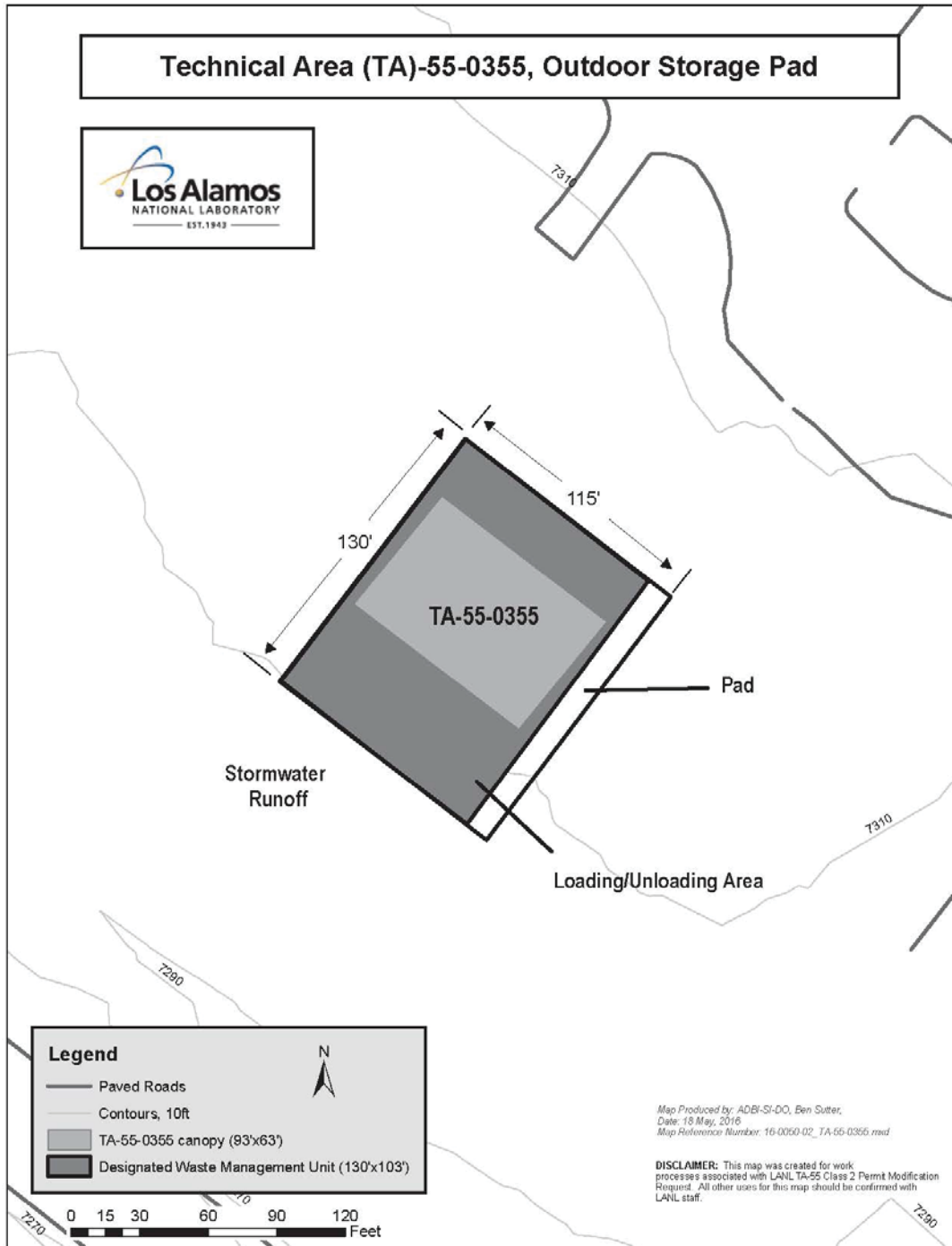

Figure 55-3
Outdoor Container Storage Unit Technical Area (TA) 55-0355 Pad

Document: LANL General Part A
Revision No.: 9.0
Date: August 2018

Figure 55-4

Technical Area (TA) 55, Building 4, Basement Floor Plan

[This figure has been provided to the New Mexico Environment Department under separate cover as Unclassified Controlled Nuclear Information (UCNI) defined by Section 148 of the Atomic Energy Act.]

Figure 55-5

Technical Area (TA) 55, Building 4, First Floor Plan

**[This figure has been provided to the New Mexico Environment Department under separate cover as
Unclassified Controlled Nuclear Information (UCNI) defined by Section 148 of the Atomic Energy Act.]**

Document: LANL General Part A
Revision No.: 9.0
Date: August 2018

Document: LANL General Part A
Revision No.: 9.0
Date: August 2018

Aerial Photograph of TA-55

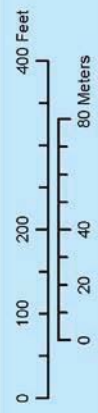

New Mexico State Plane Coordinate System
North American Datum 1983
2014 Orthophotography June 21, 2017
Map # 17-30-03-09



TA-55-4, Basement, Process Code S01, Container Storage Unit (B40)
(View is looking southeast)



TA-55-4, Basement, Process Code S01, Container Storage Unit (B40)
(View is looking southwest)



TA-55-4, Basement, Container Storage Unit B05,
Process Code S01, Container Storage Unit



TA-55-4, Basement, Container Storage Unit K13,
Process Code S01, Container Storage Unit



TA-55-4, Basement, Container Storage Unit B45,
Process Code S01, Container Storage Unit



TA-55-4, Room 401, Stabilization Unit Pencil Tanks Component,
Process Code S02, Storage Tank System



TA-55-4, Room 401, Evaporator Glovebox Tanks Component
Process Code S02, Storage Tank System



TA-55-4, Room 401, Stabilization Unit
Process Code T04, Treatment Unit



TA-55, Near Building 4, Outdoor Pad,
Process Code S01, Container Storage



TA-55-0355 Pad
Process Code S01, Outdoor Container Storage

Document: LANL General Part A
Revision No.: 9.0
Date: August 2018

Photo

TA-55-4, Basement, Process Code S01, Container Storage Unit (Vault)

**[This figure has been provided to the New Mexico Environment Department under separate cover as
Unclassified Controlled Nuclear Information (UCNI) defined by Section 148 of the Atomic Energy Act.]**

Document: LANL General Part A
Revision No.: 9.0
Date: August 2018

Photo

TA-55-4, Basement, Process Code S01, Container Storage Unit (B13)

**[This figure has been provided to the New Mexico Environment Department under separate cover as
Unclassified Controlled Nuclear Information (UCNI) defined by Section 148 of the Atomic Energy Act.]**

Document: LANL General Part A
Revision No.: 9.0
Date: August 2018

Photo

TA-55-4, Basement, Process Code S01, Container Storage Unit (G12)

**[This figure has been provided to the New Mexico Environment Department under separate cover as
Unclassified Controlled Nuclear Information (UCNI) defined by Section 148 of the Atomic Energy Act.]**

Topographic Map Showing the Location of Hazardous Waste Management Units at Technical Area 55

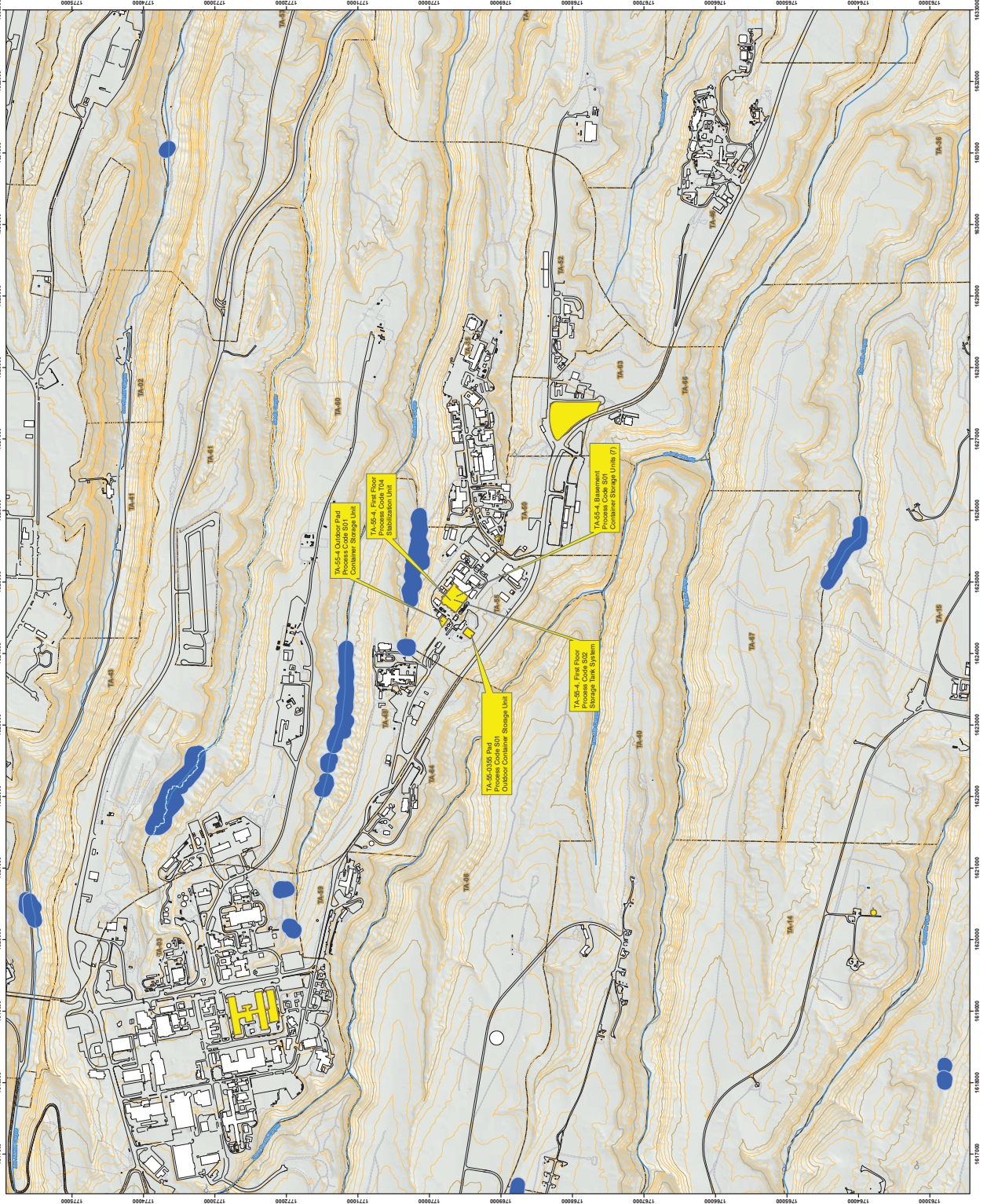

Legend

- Springs
- Streams, Perennial
- Drainage
- Roads, paved
- Roads, dirt
- Contours, 20 ft
- Contours, 100 ft
- Hazardous Waste Management Unit
- Structures
- TAs
- Wetlands



State Plane Coordinate System, New Mexico Central Zone,
1983 North American Datum, NGVD 1929
Map Units in feet.

Grid provides **NAD** State Plane coordinates in feet.
Grid Interval: 1000 ft

DISCLAIMER: This map was created for work processes associated with RCRA Permit.
All other uses for this map should be confirmed with ENV-RCRA staff.

Map Produced by ADR&S, Ben Suter
Map Date: 12/20/2016
Map Reference Number: 17-0042-081_T455

Technical Area (TA) 63

**EXPLANATION OF PROCESS CODE LISTINGS
AND DESIGN CAPACITIES AT TECHNICAL AREA (TA) 63**

Description	Capacity (gallons)	Associated Structure No./Area	Co-Operator
<u>Item 6, Line 23 S01 Container Storage Units</u>			
Container storage within the fenced portion of Transuranic Waste Facility (for RCRA ¹ -regulated waste)	105,875	TA-63-0149, TA-63-0150, TA-63-0151, TA-63-0152, TA-63-0153, TA-63-0154, TA-63-0155, TA-63-0156, TA-63-0157, and TA-63 Outdoor Storage Pad	DOE/Triad
TOTAL S01	105,875		

¹RCRA is the Resource Conservation and Recovery Act.

**EXPLANATION OF PROCESS CODE LISTINGS
AND DESIGN CAPACITIES AT TECHNICAL AREA (TA) 63
(Continued)**

Description	Capacity (gallons)	Associated Structure No./Area	Co-Operator
<u>Item 6, Line 24 T04 Treatment - Other</u>			
Macroencapsulation process for RCRA ¹ - regulated waste	23,160	Within container storage unit at the Transuranic Waste Facility including TA-63-0149, TA-63-0150, TA-63-0151, TA-63-0152, TA-63-0153, TA-63-0154, TA-63-0155, TA-63-0156, TA-63-0157, and the Outdoor Pad	DOE/Triad
TOTAL T04	23,160		

¹ RCRA is the Resource Conservation and Recovery Act.

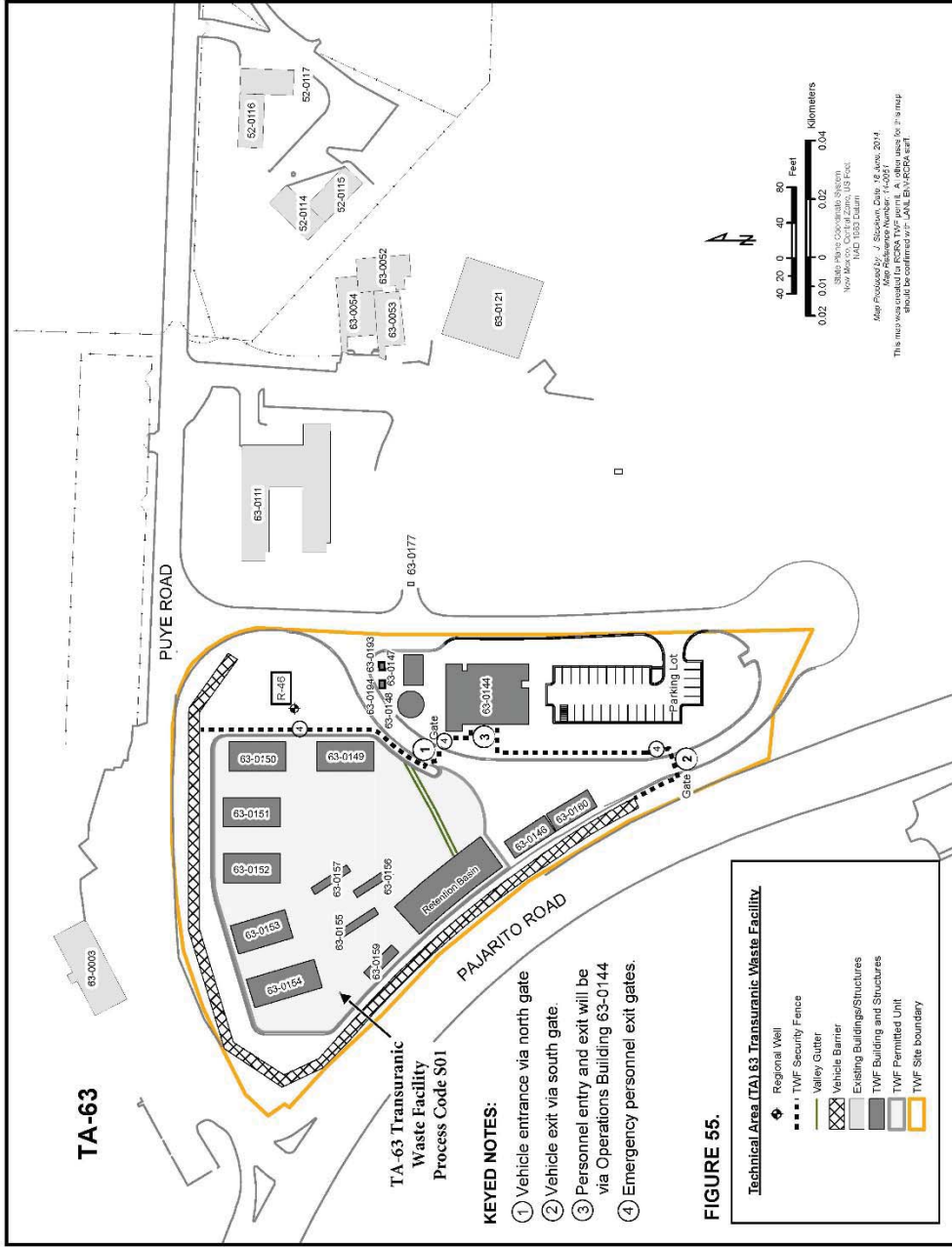

Figure 63-1
 Technical Area (TA) 63, Transuranic Waste Facility Plan

Document: LANL General Part A
Revision No.: 9.0
Date: August 2018

Document: LANL General Part A
Revision No.: 9.0
Date: August 2018

Aerial Photograph of TA-63



Permitted Unit Boundary
TWF Site Boundary

New Mexico State Plane Coordinate System
Central Zone US FT
North American Datum 1983
2017 Google Earth Imagery
Map Created By Ben Sutter, December 5, 2017
Map # 17-0042-10-Aerial_TA63



TA-63-0150
Process Code S01, Container Storage Unit



TA-63-0151
Process Code S01, Container Storage Unit



TA-63-0152
Process Code S01, Container Storage Unit



TA-63-0153
Process Code S01, Container Storage Unit



TA-63-0154
Process Code S01, Container Storage Unit



TA-63-0155
Process Code S01, Characterization Trailer



TA-63-0157
Process Code S01, Characterization Trailer

Topographical Map Showing the Location of the RCRA-Regulated Waste Management Unit at Technical Area (TA) 63

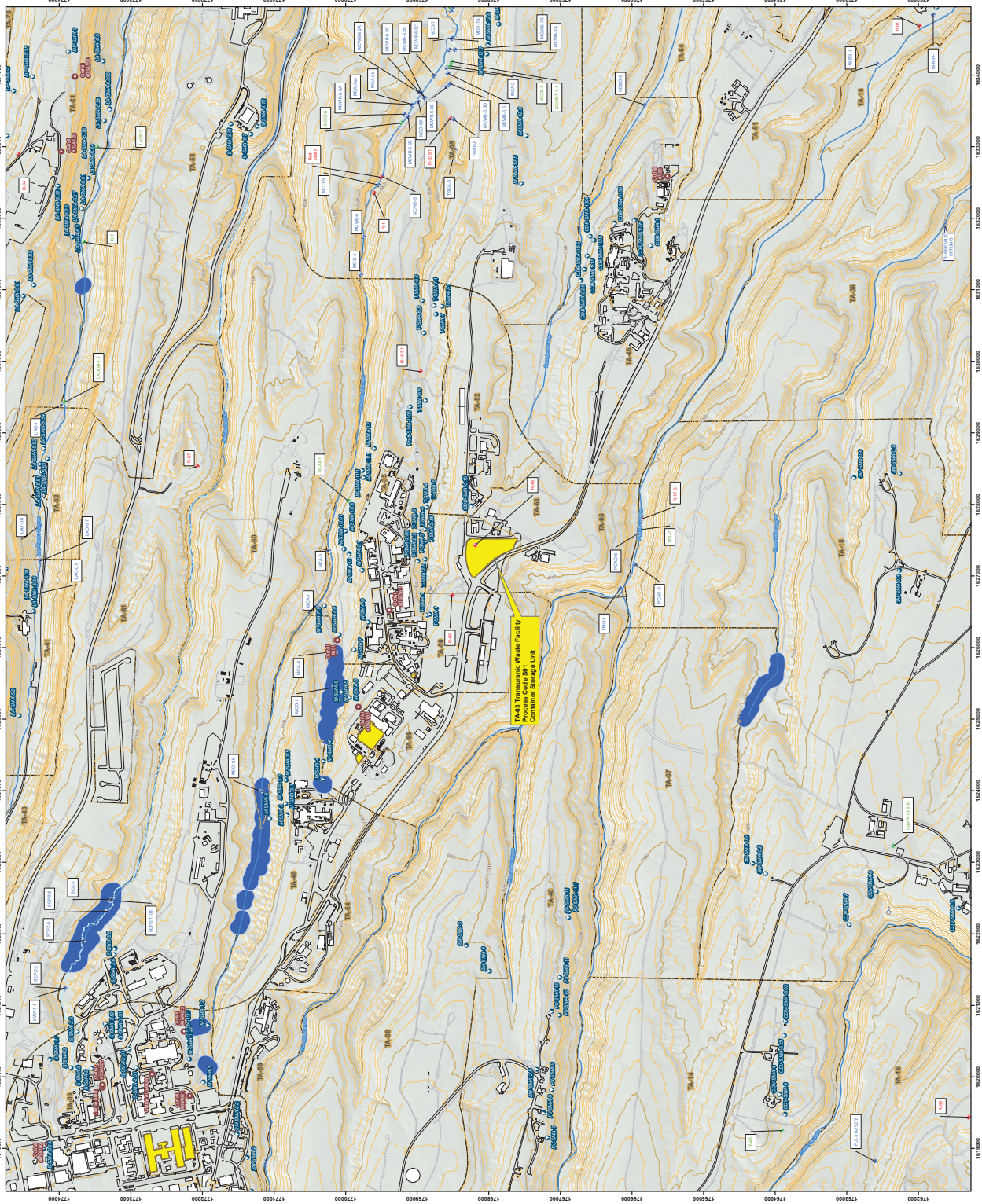

Legend

- 2017 Monitoring Wells
 - Alluvial
 - Intermediate
 - Regional
- NPDES Permitted Outfalls
- Site Monitoring Areas (SMAs)
- Springs
- Streams, Perennial
- Drainage
- Roads, paved
- Roads, dirt
- Contours, 20 ft
- Contours, 100 ft
- RCRA-Regulated Waste Management Unit
- Structures
- Wetlands
- TAs

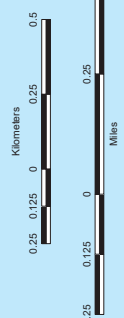

State Plane Coordinate System, New Mexico Central Zone.
1983 North American Datum.
Map Units in Feet.

Grid provides NAD State Plane coordinates in feet.
Grid Interval: 1000 ft

DISCLAIMER: This map was created for work processes associated with RCRA Permit. All other users for this map should be confirmed with ENV/RCRA staff.
Note: Labeled wells, outfalls, springs, and SMAs are within 1 mile of TA-63.

GIS Ben Suter, ADRS-SI
Date: 20 June, 2017
Map Number: 17-042-07

Document: LANL General Part A
Revision No.: 9.0
Date: August 2018

CLOSED
Los Alamos National Laboratory
Waste Management Units

LIST OF FIGURES

<u>Figure No.</u>	<u>Title</u>
1	Technical Area (TA) 3, Building 102, Container Storage Unit Closed Under Interim Status
2	Technical Area (TA) 16, Building 394, Open Burning Unit Closed Under Interim Status
3	Technical Area (TA) 16, Surface Impoundment Closed Under Interim Status
4	Technical Area (TA) 16, Closed Incinerator
5	Technical Area (TA) 16, Closed Sand Filters
6	Technical Area (TA) 16, Closed Material Disposal Area and Flash Pad
7	Technical Area (TA) 21, Building 61, Container Storage Unit Closed Under Interim Status
8	Technical Area (TA) 22, Building 24, Container Storage Unit Closed Under Interim Status
9	Technical Area (TA) 35, Building 85, Surface Impoundment Closed Under Interim Status
10	Technical Area (TA) 35, Building 125, Surface Impoundment Closed Under Interim Status
11	Technical Area (TA) 40, Scrap Detonation Unit Closed Under Interim Status
12	Technical Area (TA) 40, Building DF-2, Closed Container Storage Unit
13	Technical Area (TA) 50, Building 1, Closed Batch Waste Treatment Unit
14	Technical Area (TA) 50, Building 1, Closed Container Storage Unit (associated with the Batch Waste Treatment Unit)
15	Technical Area (TA) 50, Building 1, Room 59 Container Storage Unit Closed Under Interim Status
16	Technical Area (TA) 50, Building 114, Closed Container Storage Unit

LIST OF FIGURES (Continued)

<u>Figure No.</u>	<u>Title</u>
17	Technical Area (TA) 50, Building 37, Controlled Air Incinerator Closed Under Interim Status
18	Technical Area (TA) 50, Building 37, Closed Container Storage Unit (associated with the Controlled Air Incinerator)
19	Technical Area (TA) 50, Building 37, Storage Tanks Closed Under Interim Status
20	Technical Area (TA) 50, Building 37, Room 117, Closed Container Storage Unit
21	Technical Area (TA) 50, Building 37, Rooms 115 and 118 Container Storage Unit Closed Under Interim Status
22	Technical Area (TA) 54, Building 35, Area L, Closed Storage/Treatment Tanks
23	Technical Area (TA) 54, Area L, Closed Waste Oil Storage Tanks
24	Technical Area (TA) 55, Building 4, Closed Oxygen Sparging Treatment Furnace
25	Technical Area (TA) 55, Building 4, Closed Container Storage Unit
26	Technical Area (TA) 55, Building 185, Administratively Closed Container Storage Unit

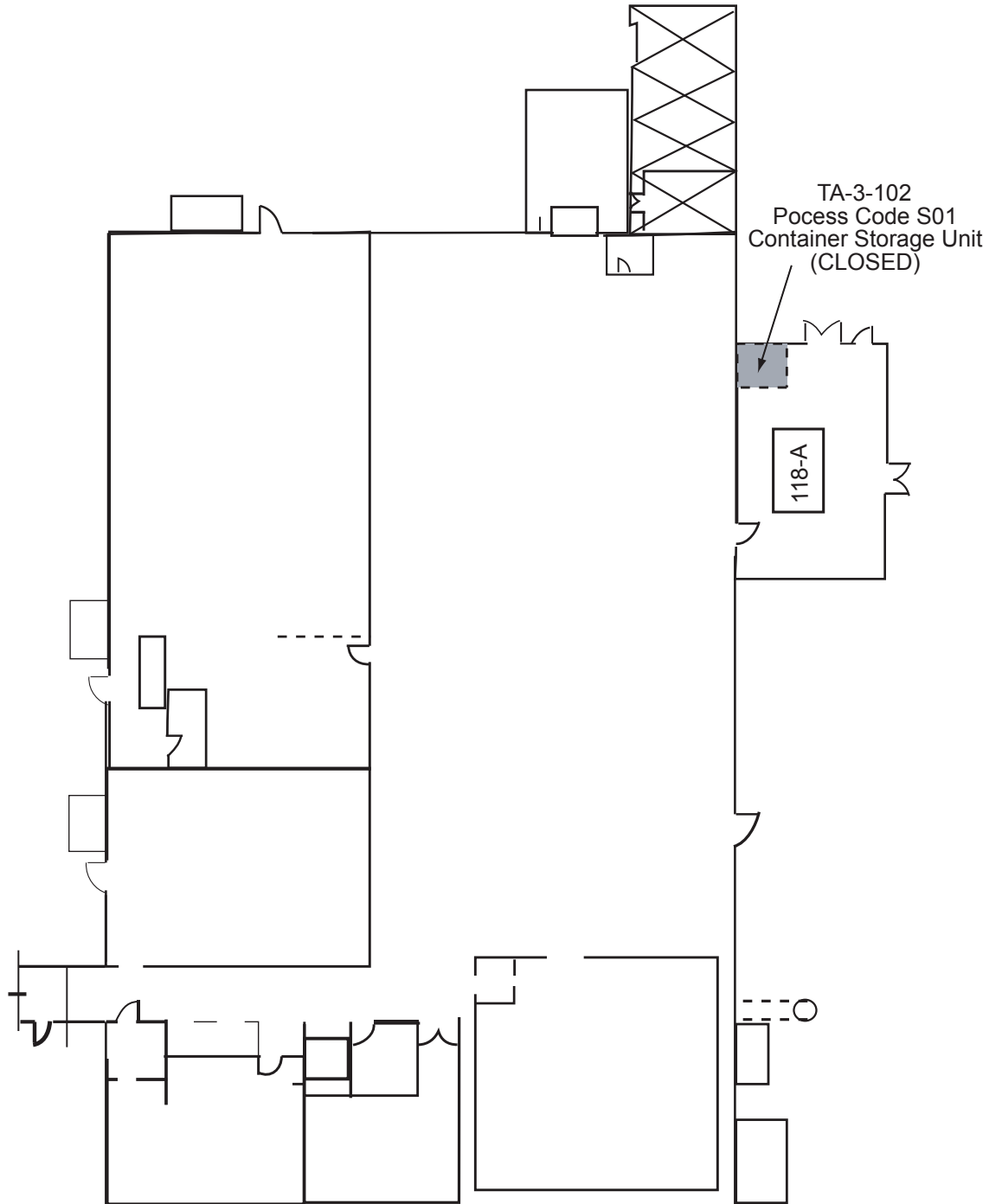

LEGEND

■ Designates Closed Waste Management Unit

Figure 1
Technical Area (TA) 3, Building 102, Container Storage Unit
Closed Under Interim Status

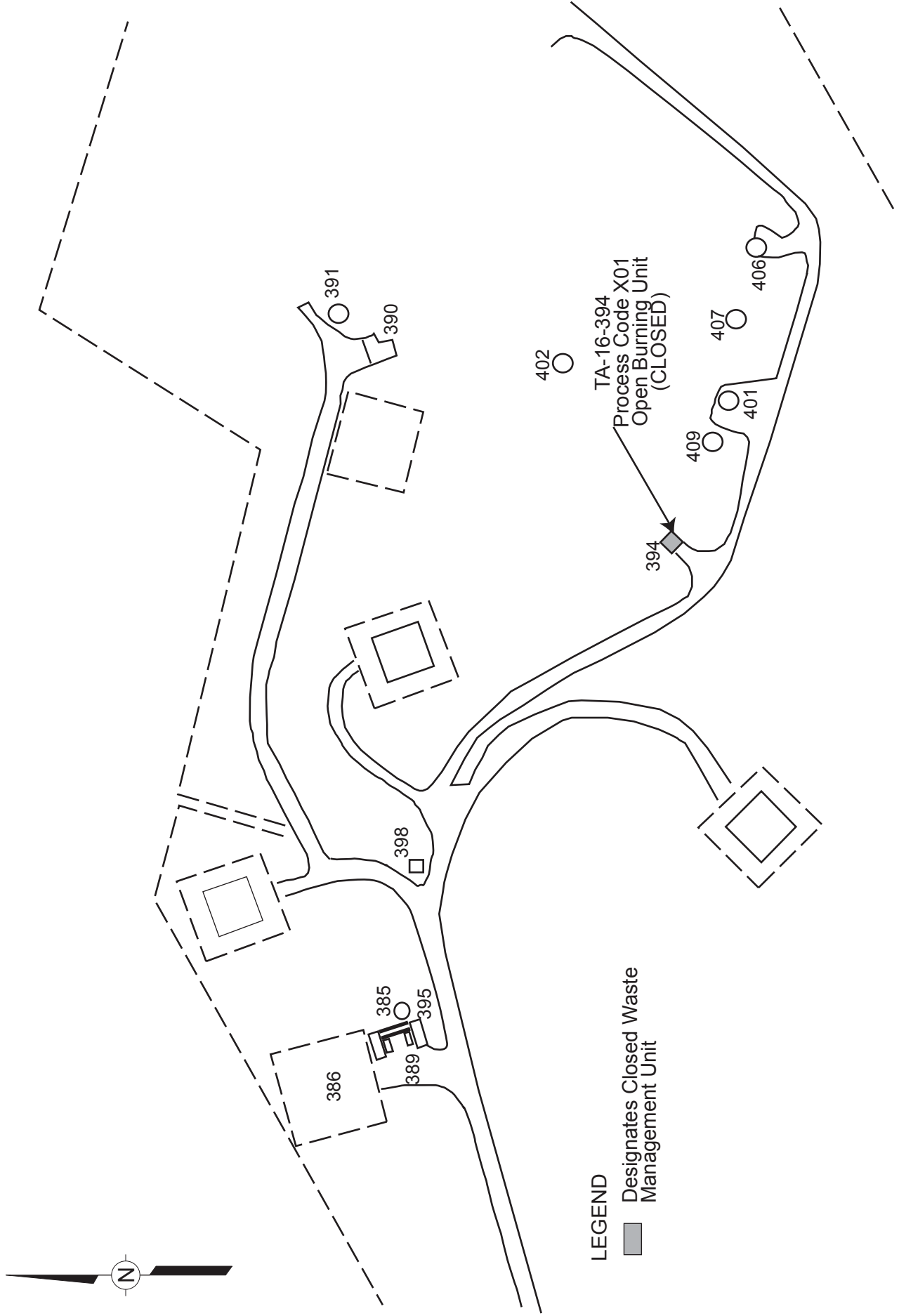

Figure 2
Technical Area (TA) 16, Building 394, Open Burning Unit
Closed Under Interim Status

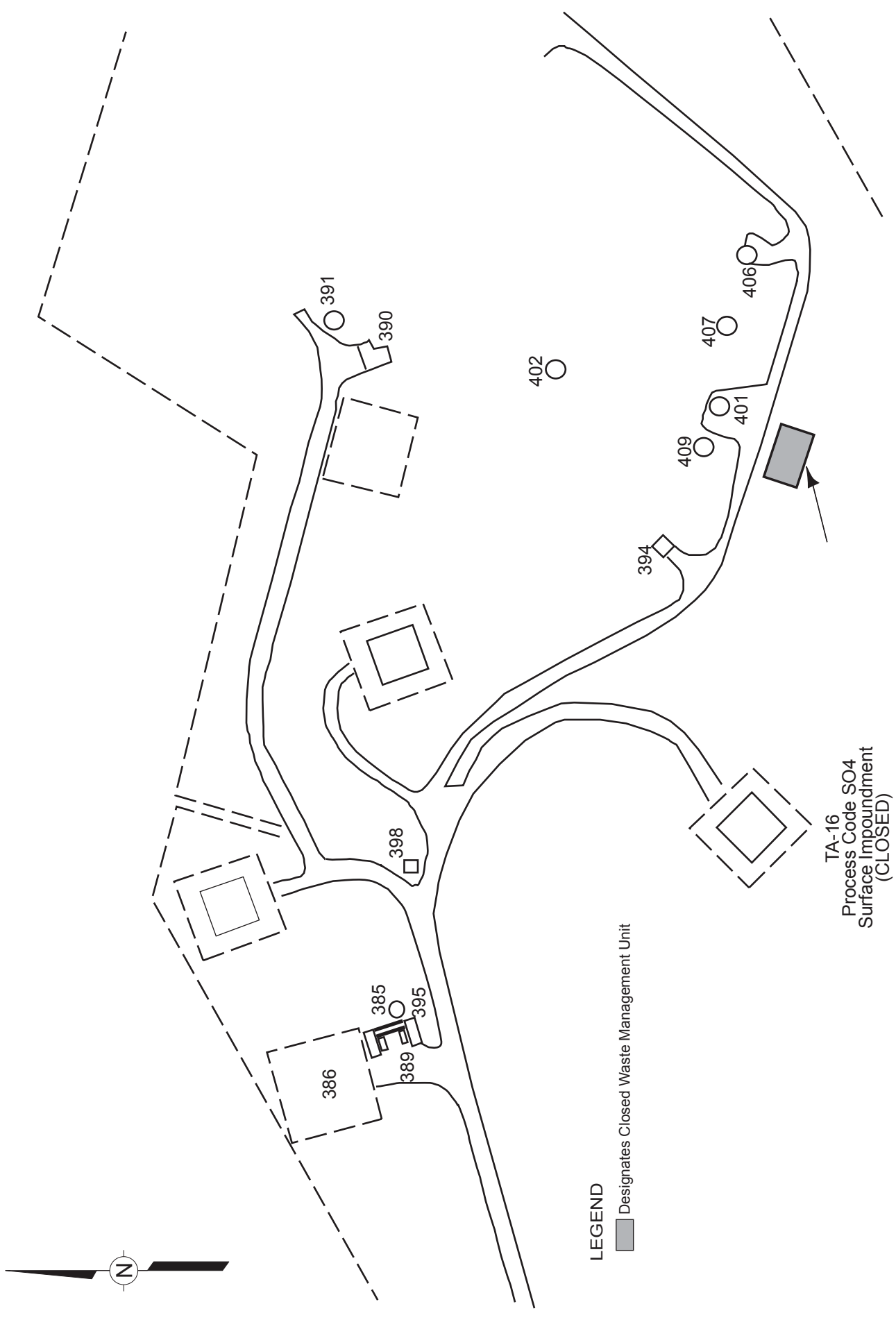

Figure 3
 Technical Area (TA) 16, Surface Impoundment Closed Under Interim Status

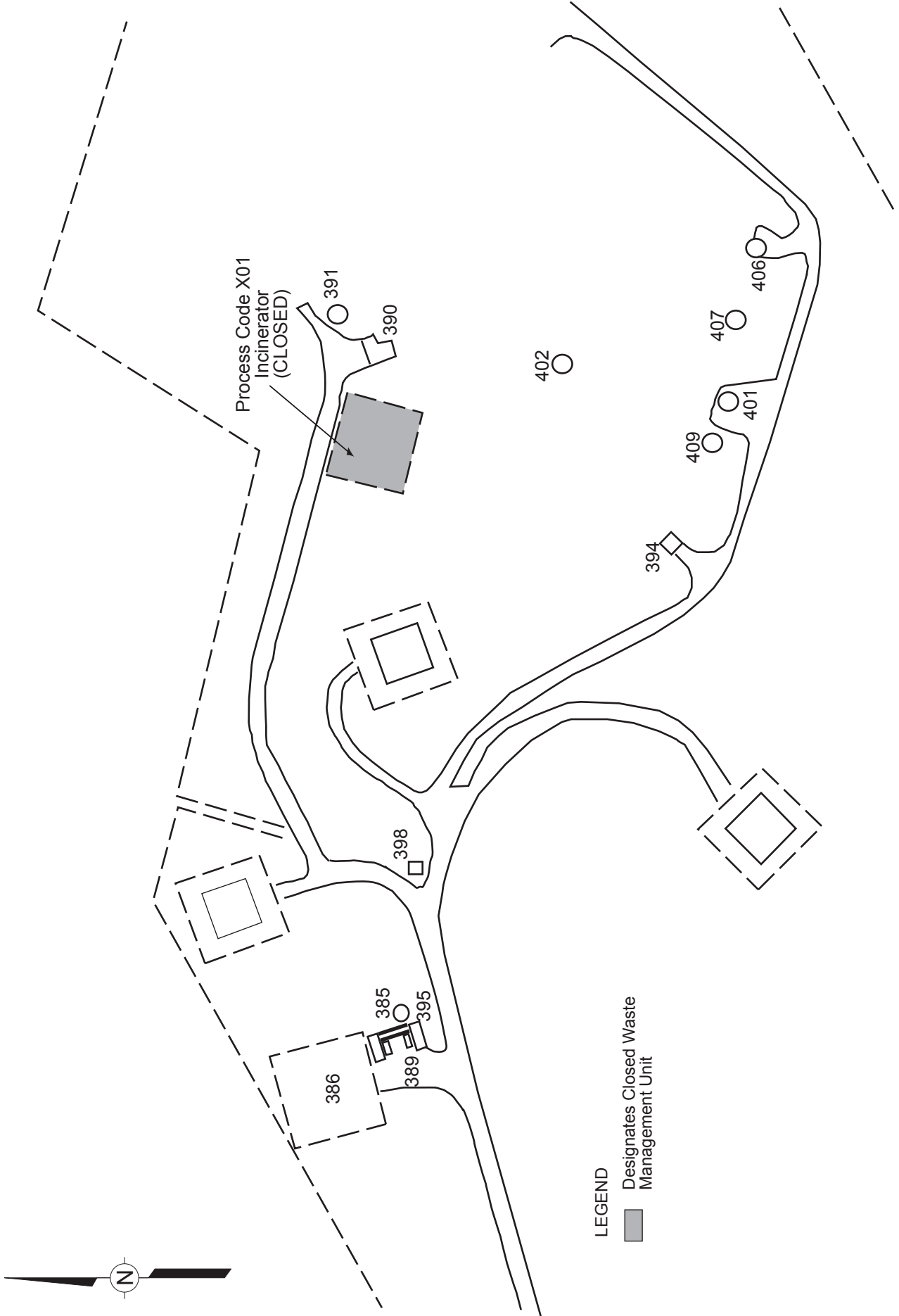

Figure 4
Technical Area (TA) 16, Closed Incinerator

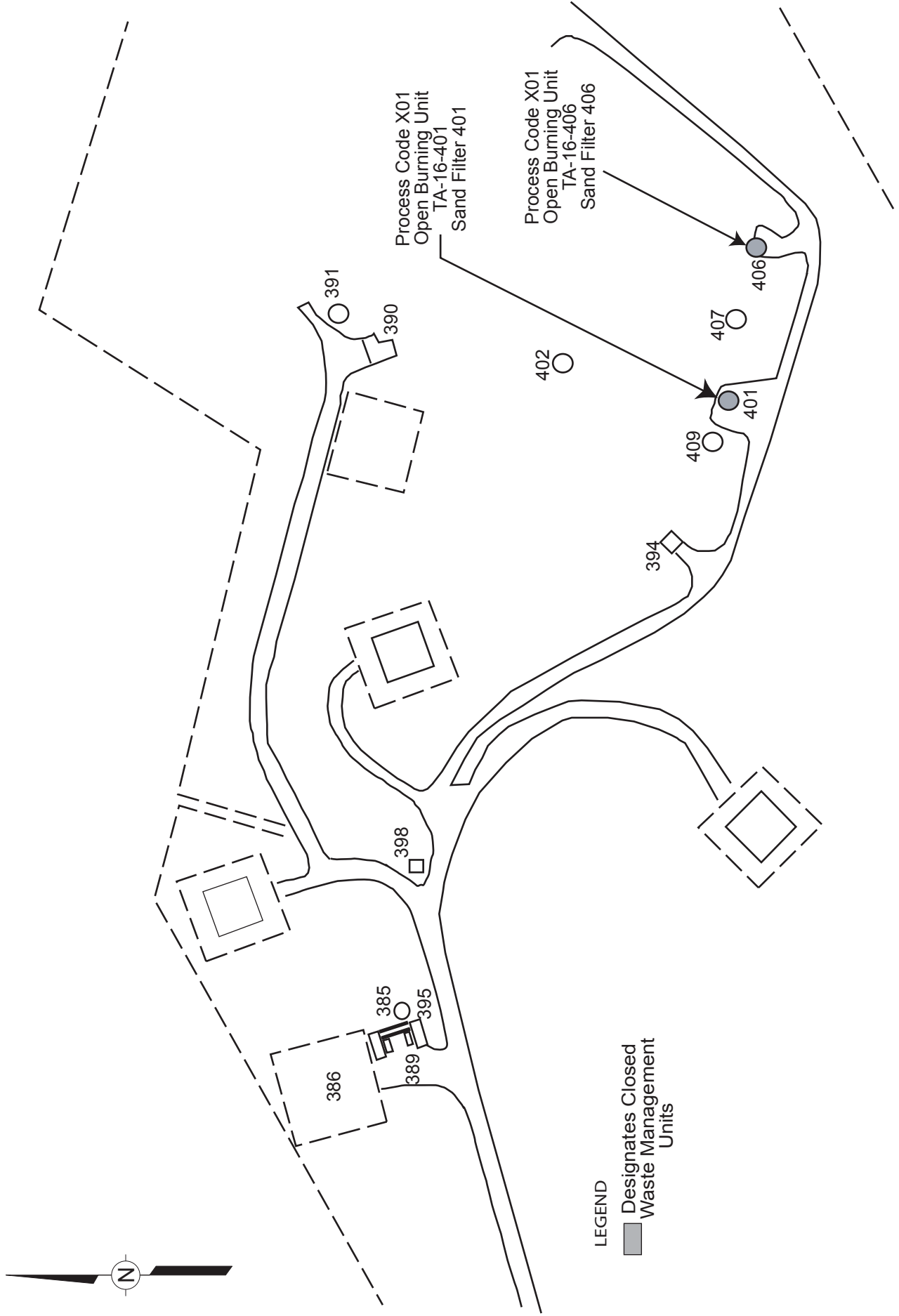

Figure 5
Technical Area (TA) 16, Closed Sand Filters

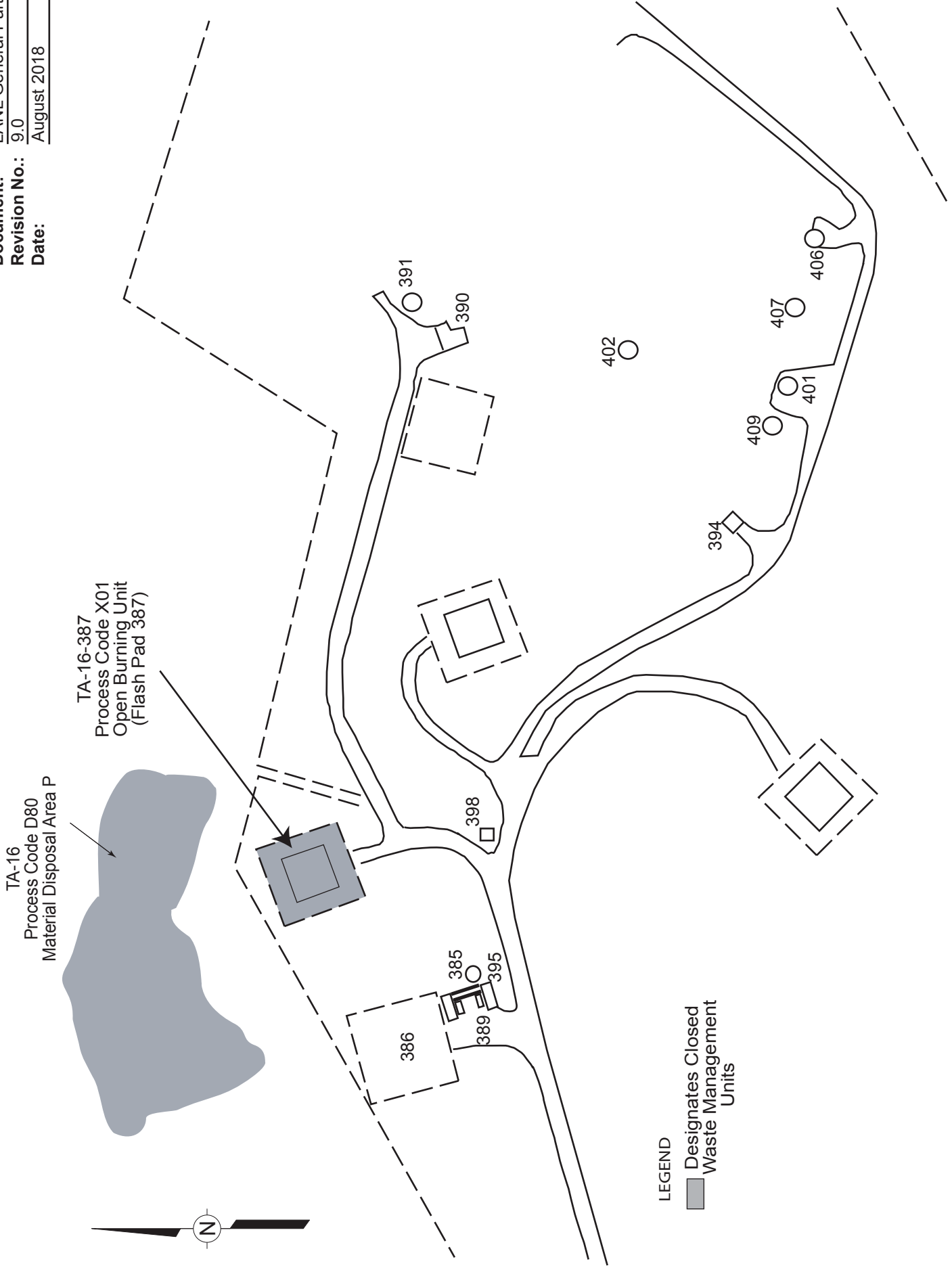
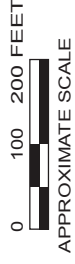
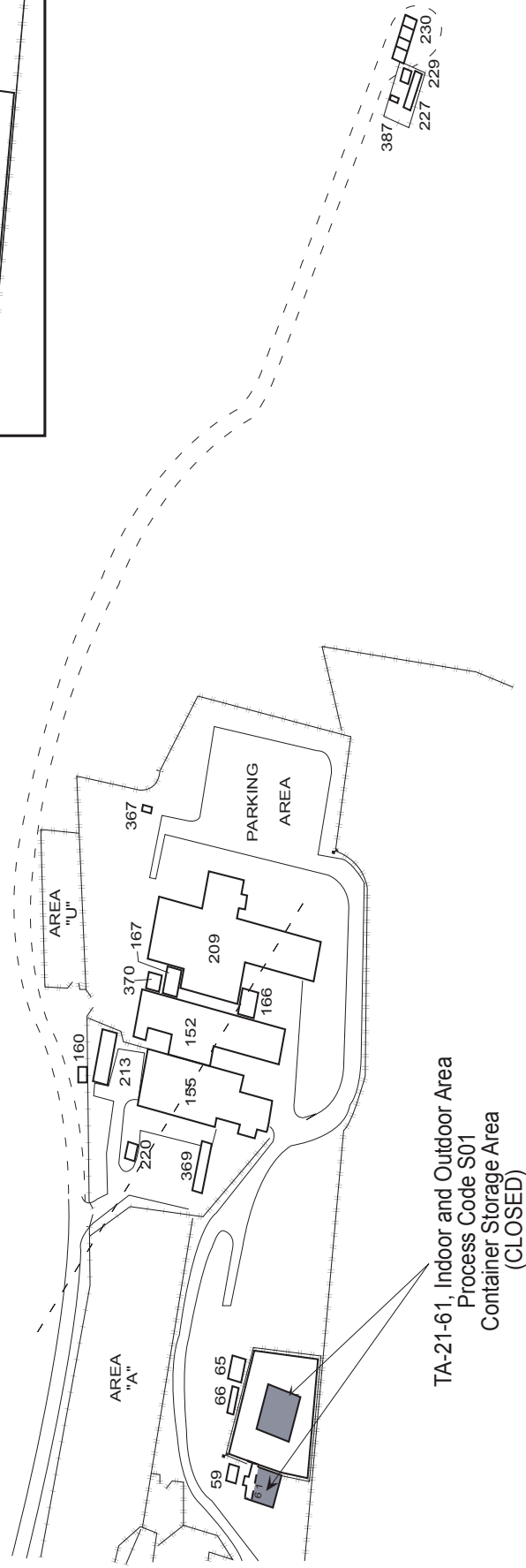
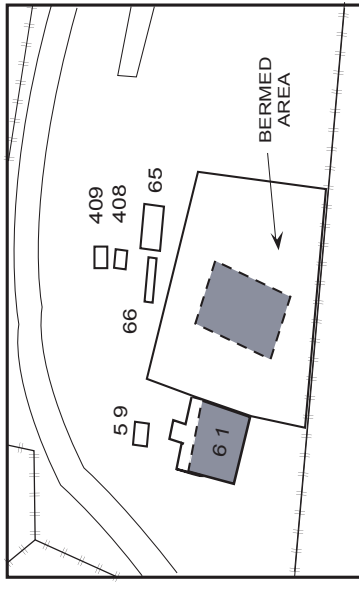

Figure 6
 Technical Area (TA) 16, Closed Material Disposal Area and Flash Pad



LEGEND
 [Grey Box] Designates Closed Waste Management Unit

Figure 7
 Technical Area 21, Building 61, Container Storage Unit
 Closed Under Interim Status

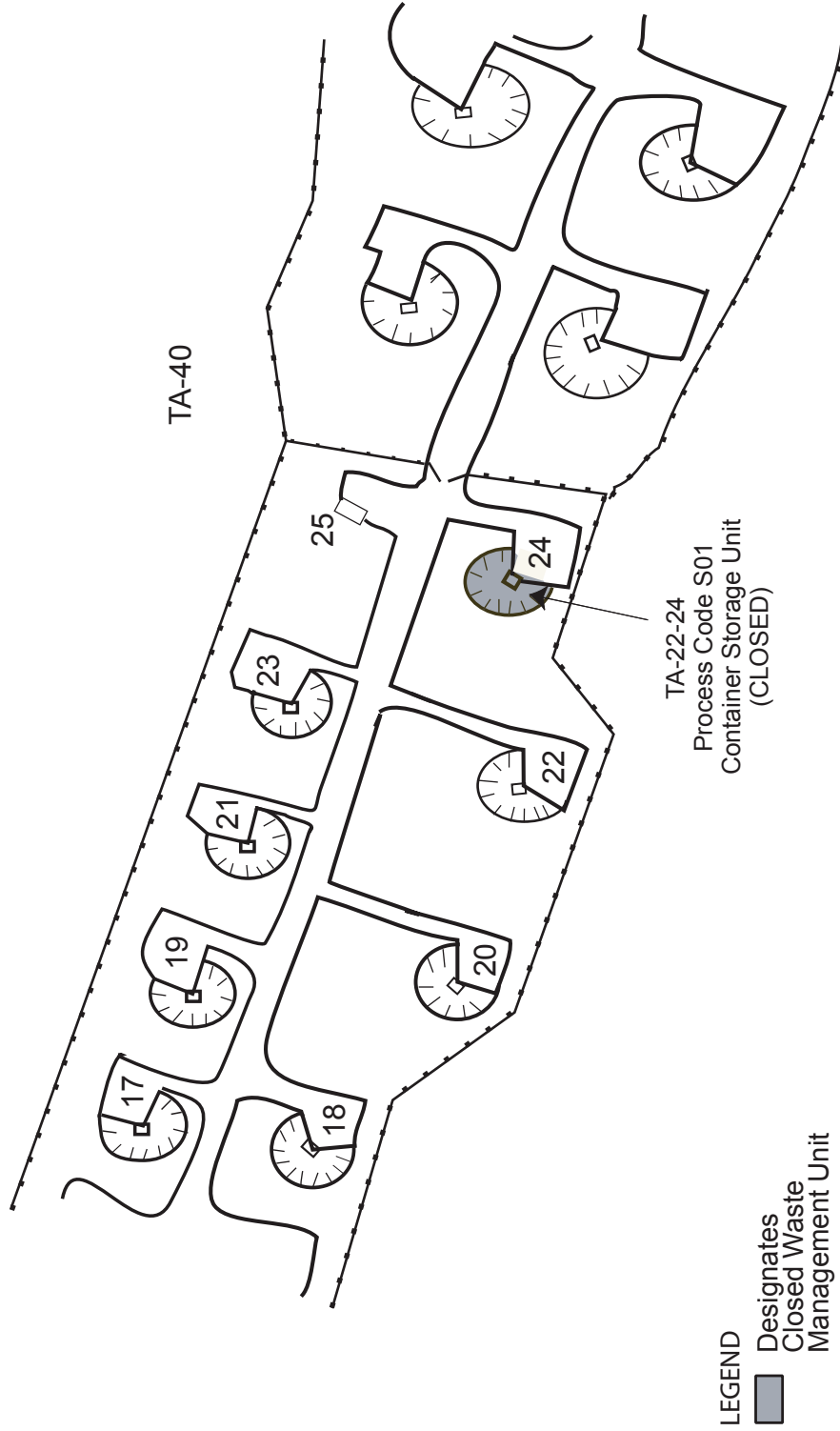

Figure 8
 Technical Area (TA) 22, Building 24, Container Storage Unit
 Closed Under Interim Status

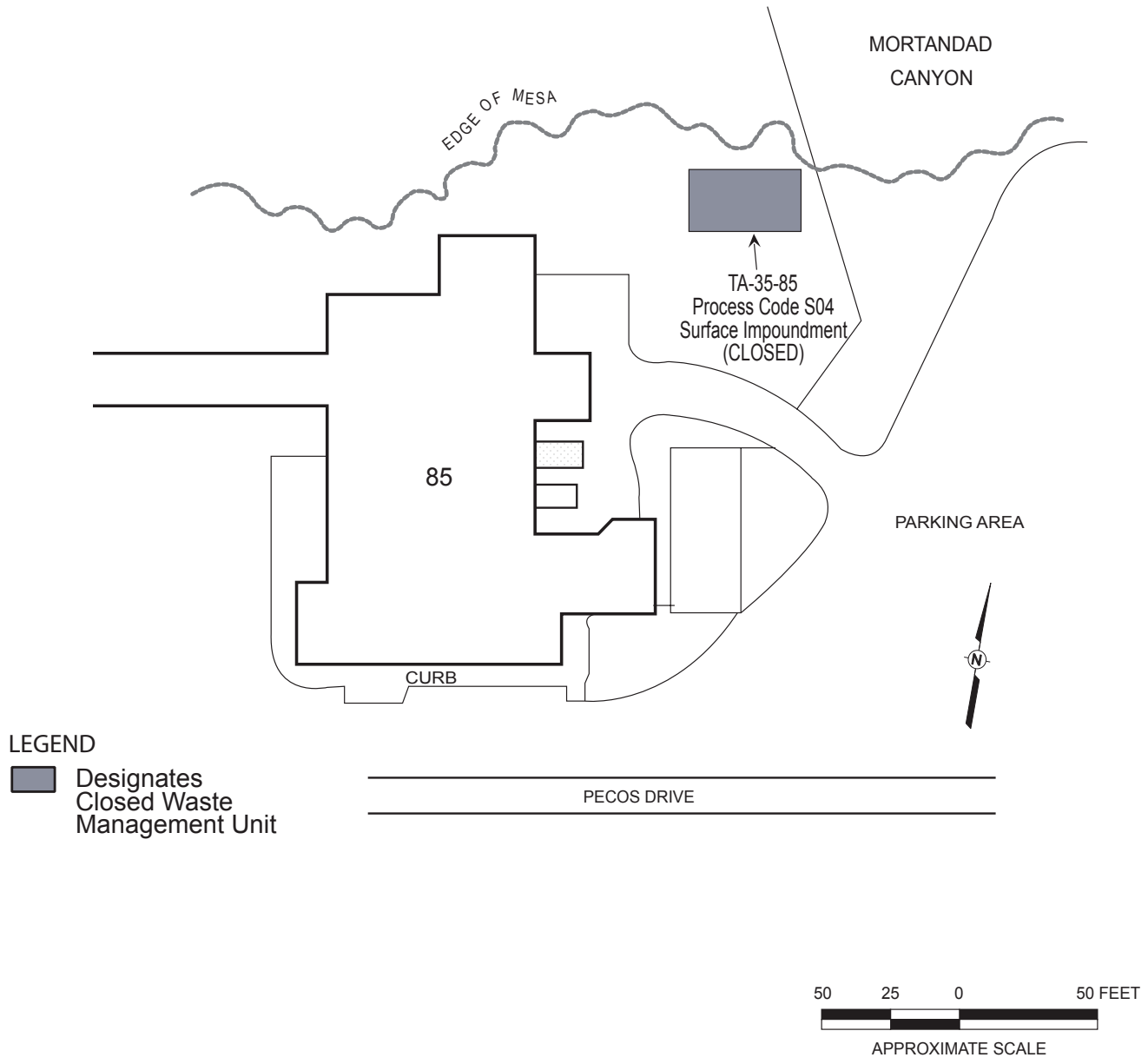
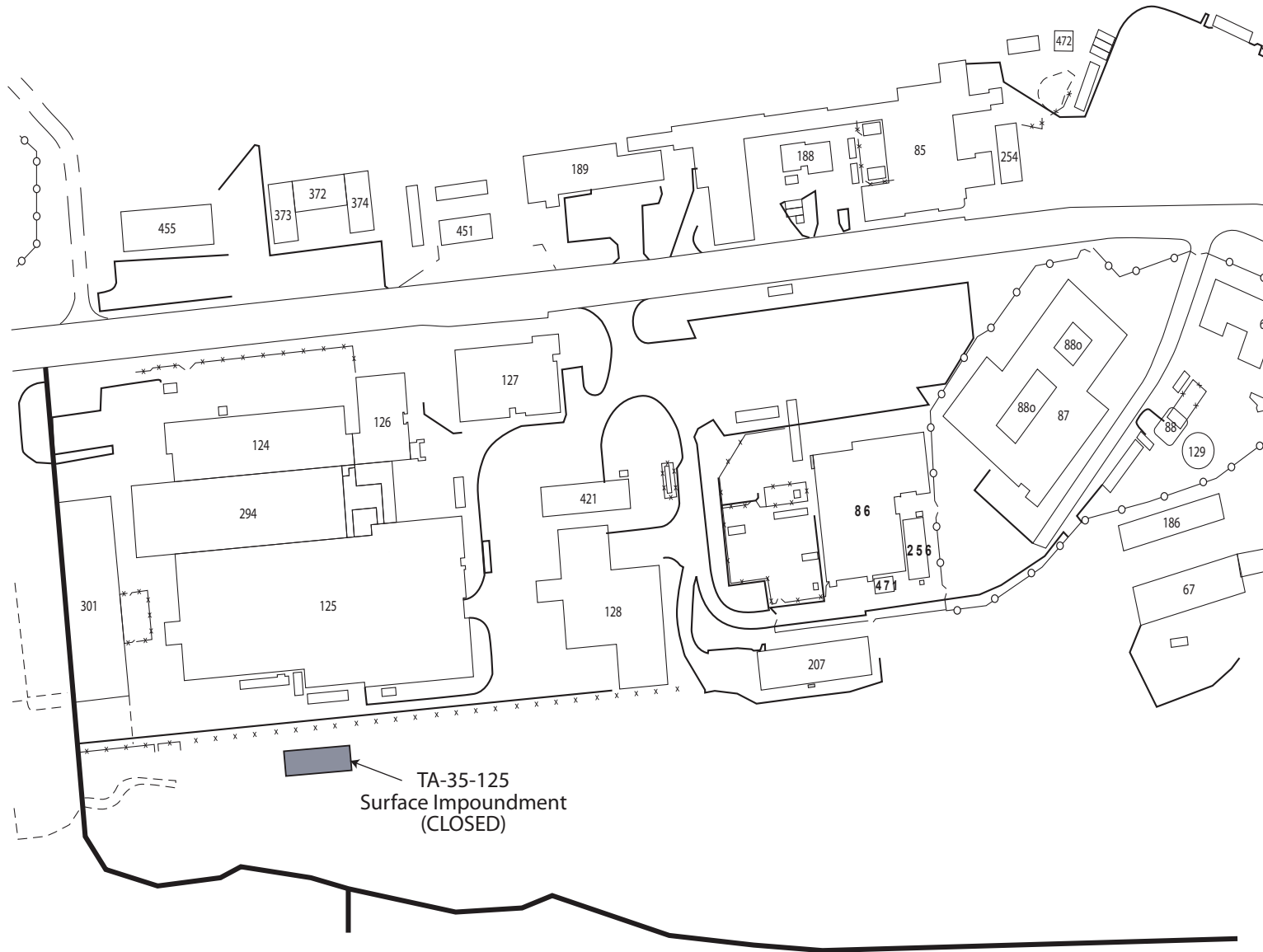

Figure 9
Technical Area (TA) 35, Building 85, Closed Under Interim, Status Storage Tanks



LEGEND





-  Boundary, Technical Area
-  Fence, Industrial
-  Fence, Security
-  Designates Closed Waste Management Unit



Figure 10
 Technical Area (TA) 35, Structure 125, Closed Under Interim Status, Surface Impoundment

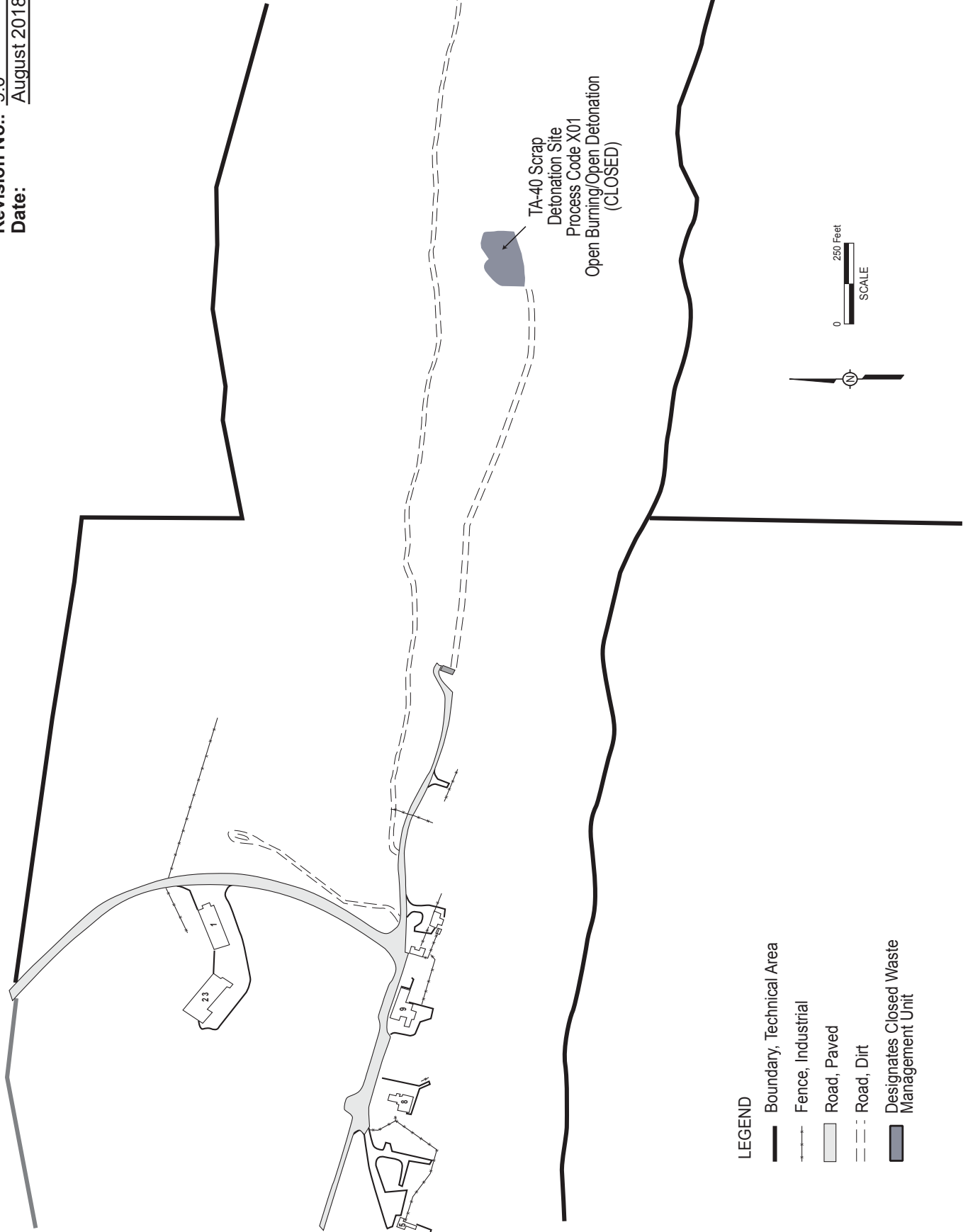

- LEGEND**
- Boundary, Technical Area
 - - - Fence, Industrial
 - ▒ Road, Paved
 - - - Road, Dirt
 - Designates Closed Waste Management Unit

Figure 11
 Technical Area (TA) 40, Closed Under Interim Status, Scrap Detonation Unit

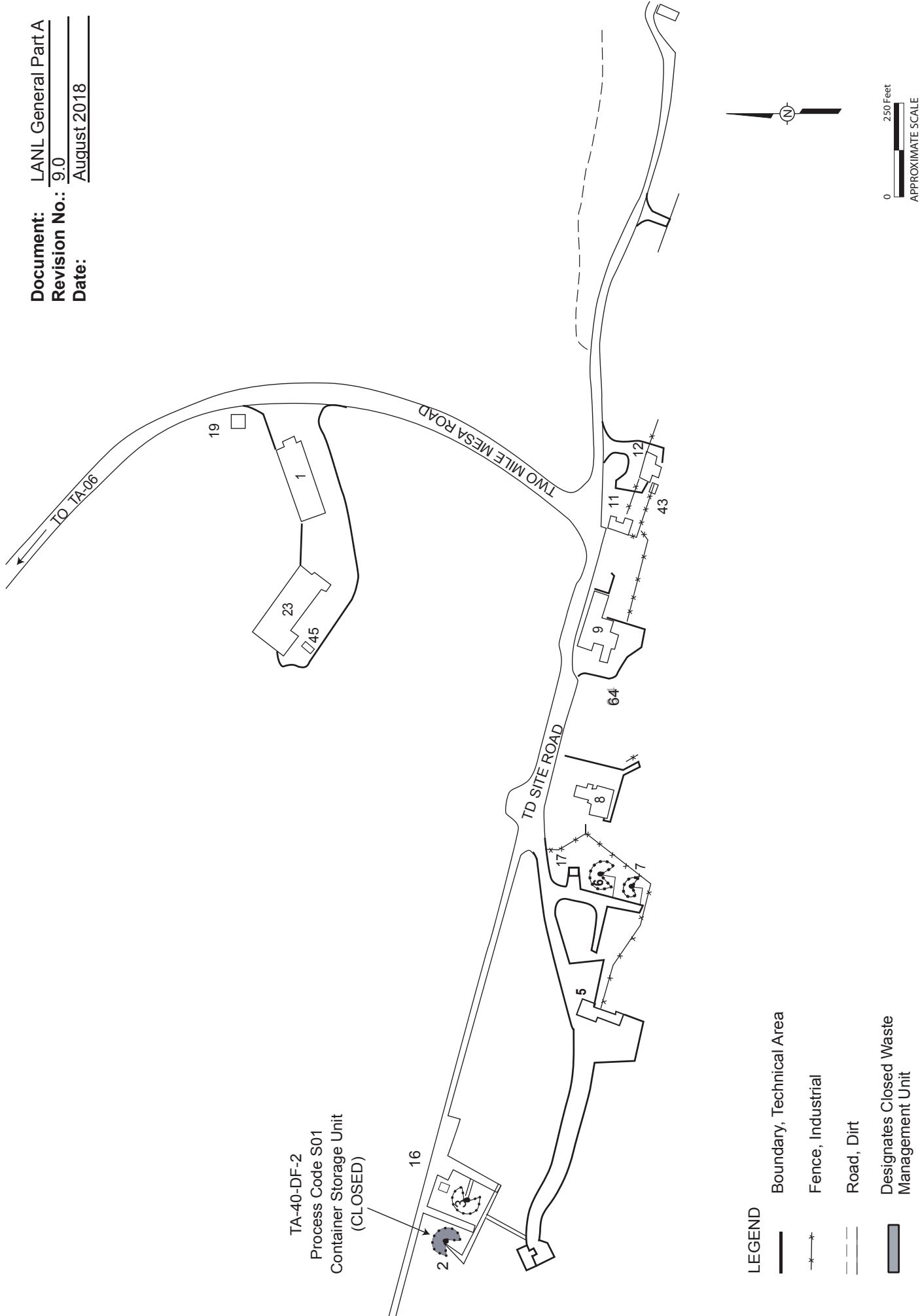
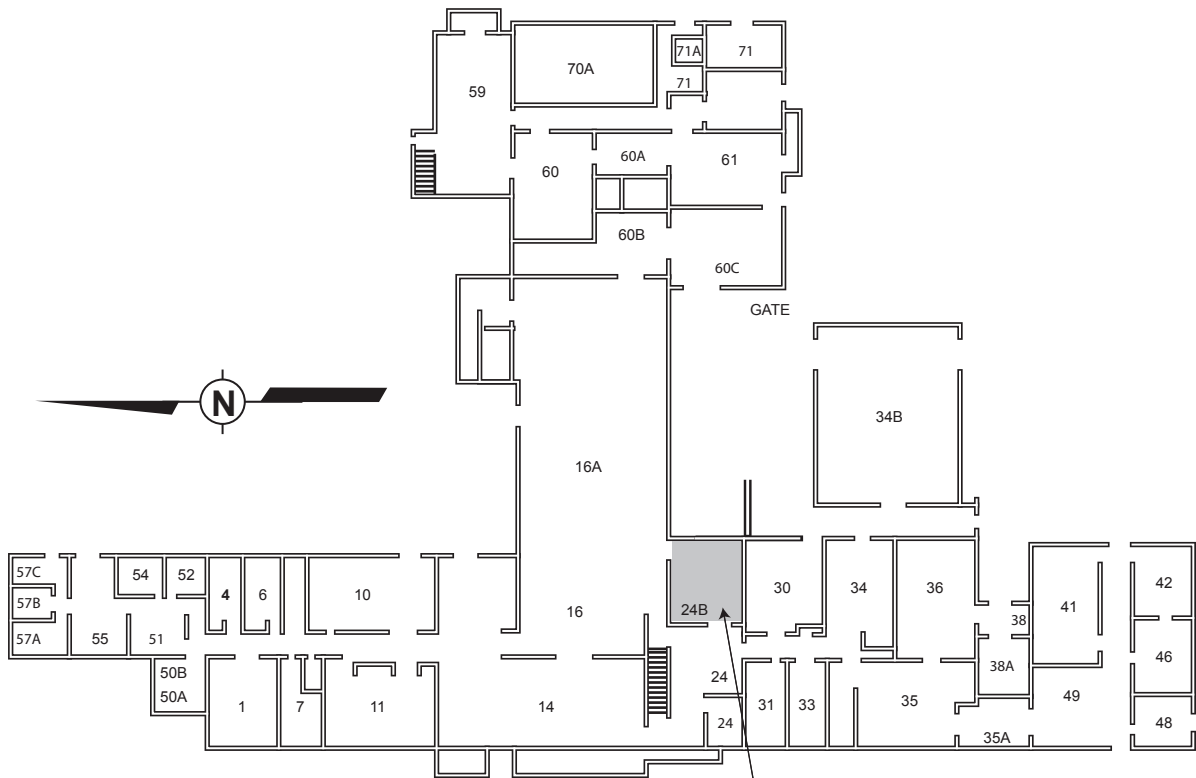

Figure 12
 Technical Area (TA) 40, Building DF-2, Closed Container Storage Unit



TA-50-1
Process Code T04
Batch Waste Treatment Unit
(CLOSED)

NOT TO SCALE

LEGEND

■ Designates
Closed Waste
Management Unit

Figure 13
Technical Area (TA) 50, Building 1, Closed Batch Waste Treatment Unit

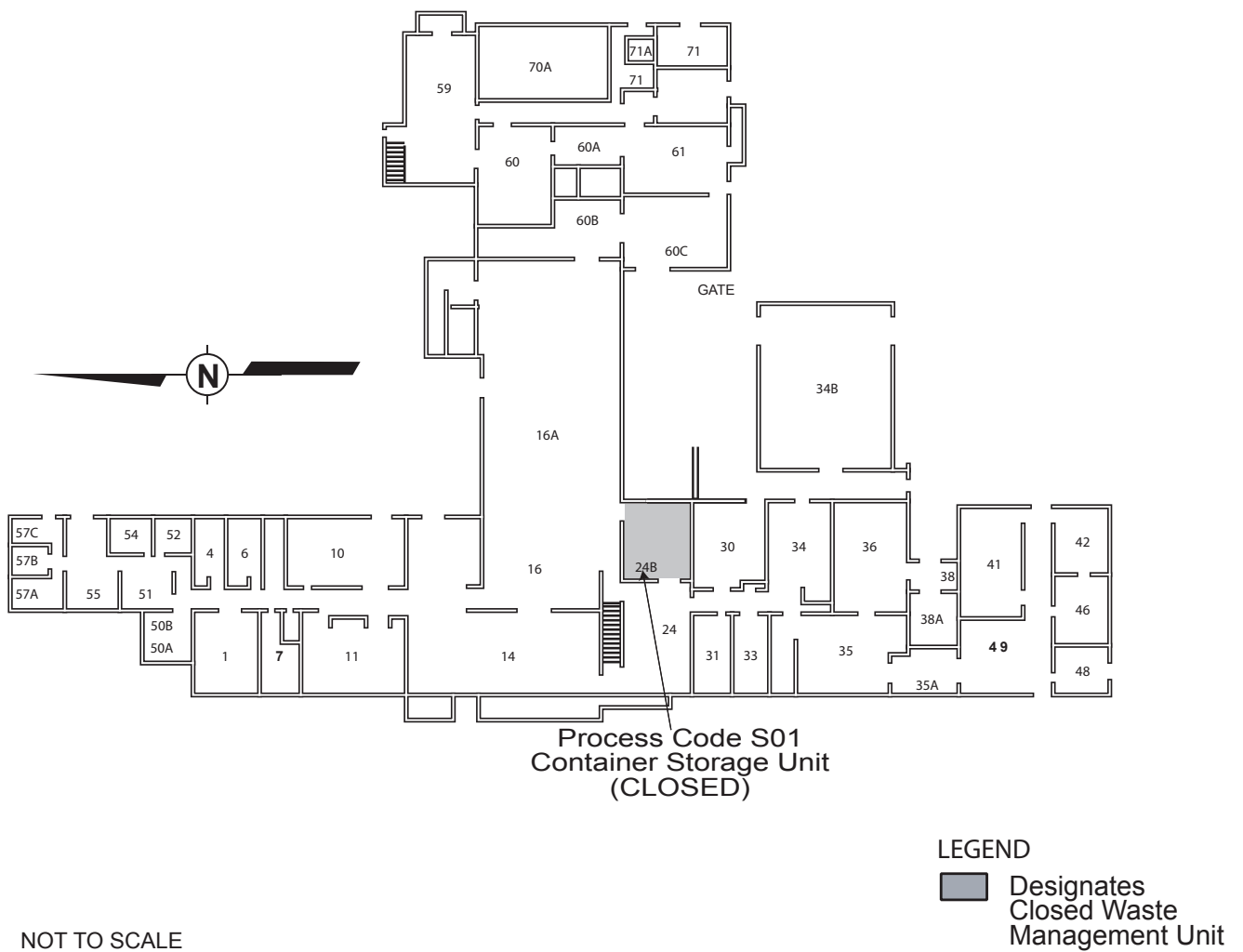

Figure 14
Technical Area (TA) 50, Building 1, Closed Container Storage Unit
(Associated with the Batch Waste Treatment Unit)

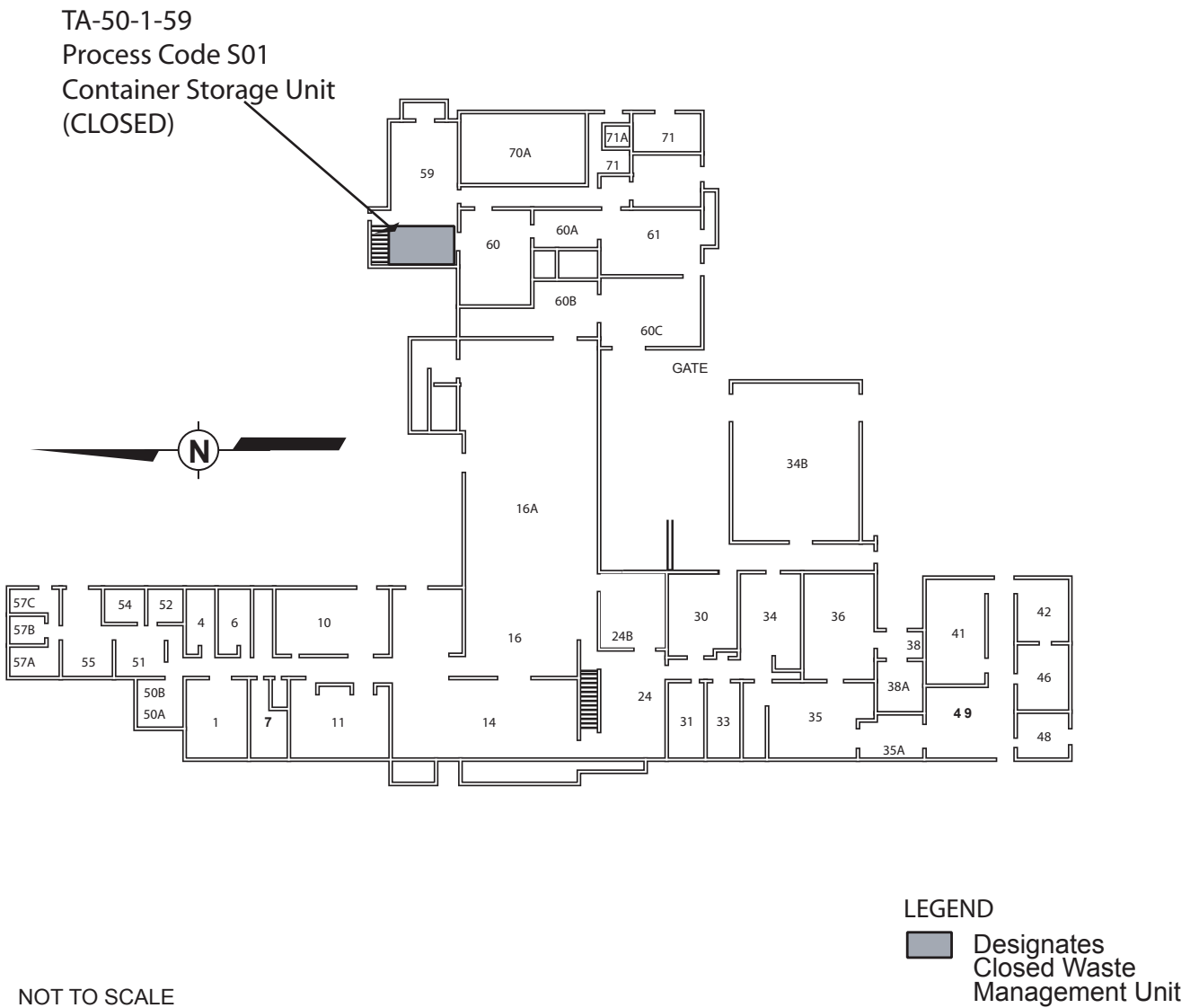

Figure 15
Technical Area (TA) 50, Building 1, Room 59 Container Storage Unit
Closed Under Interim Status

Document: LANL General Part A
Revision No.: 9.0
Date: August 2018

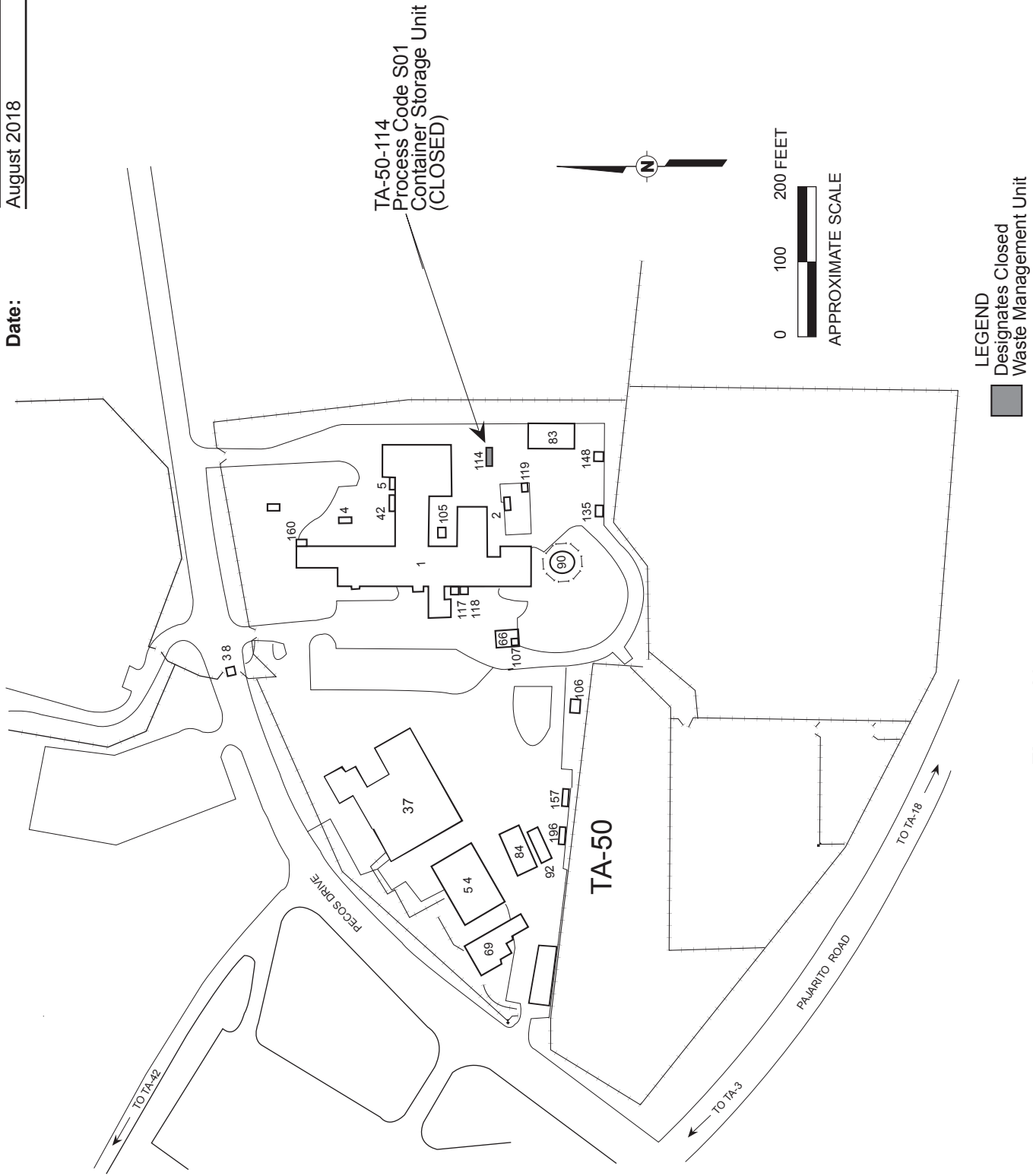

Figure 16
Technical Area (TA) 50 Building 114, Closed Container Storage Unit

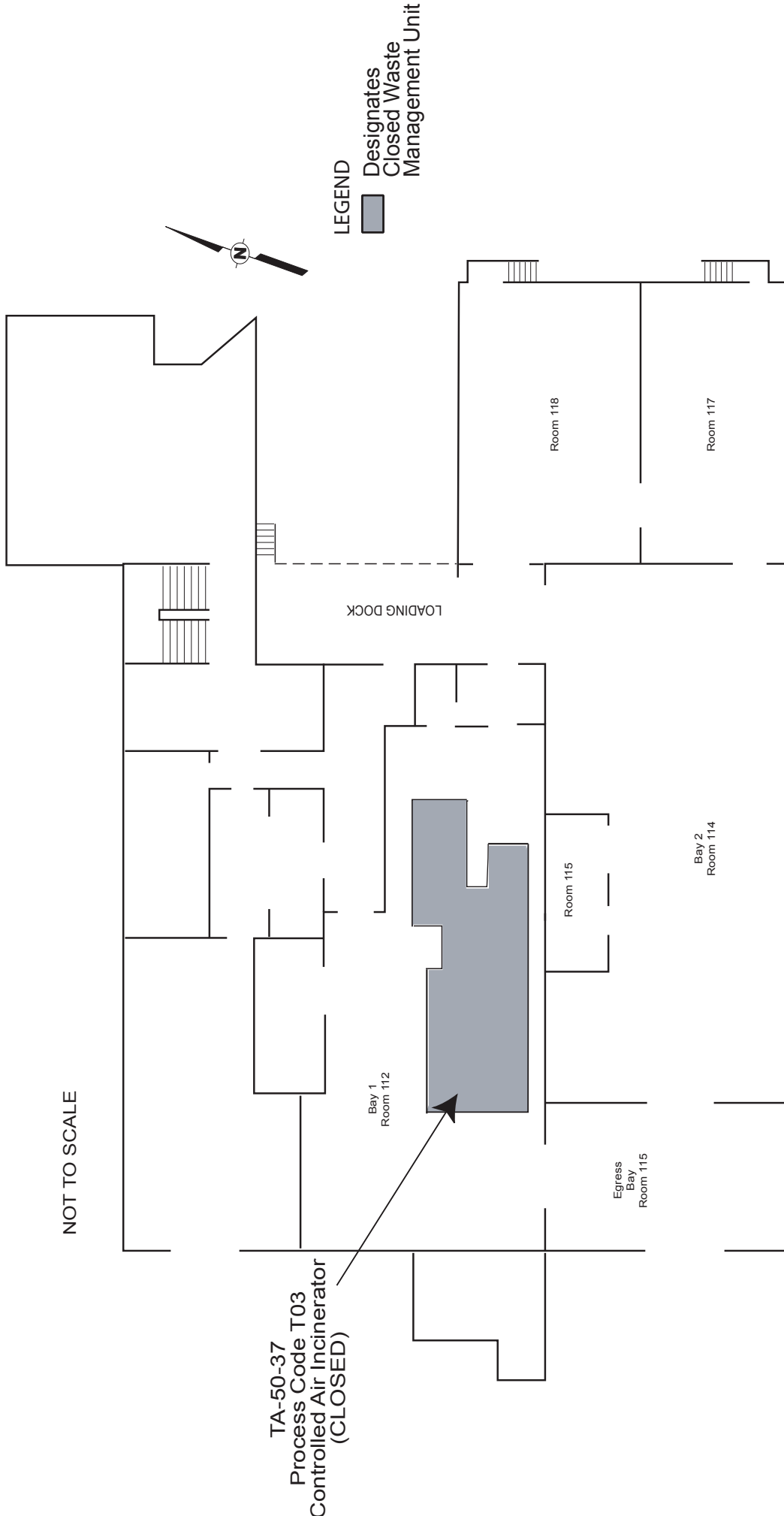

Figure 17
Technical Area (TA) 50, Building 37, Controlled Air Incinerator Closed Under Interim Status

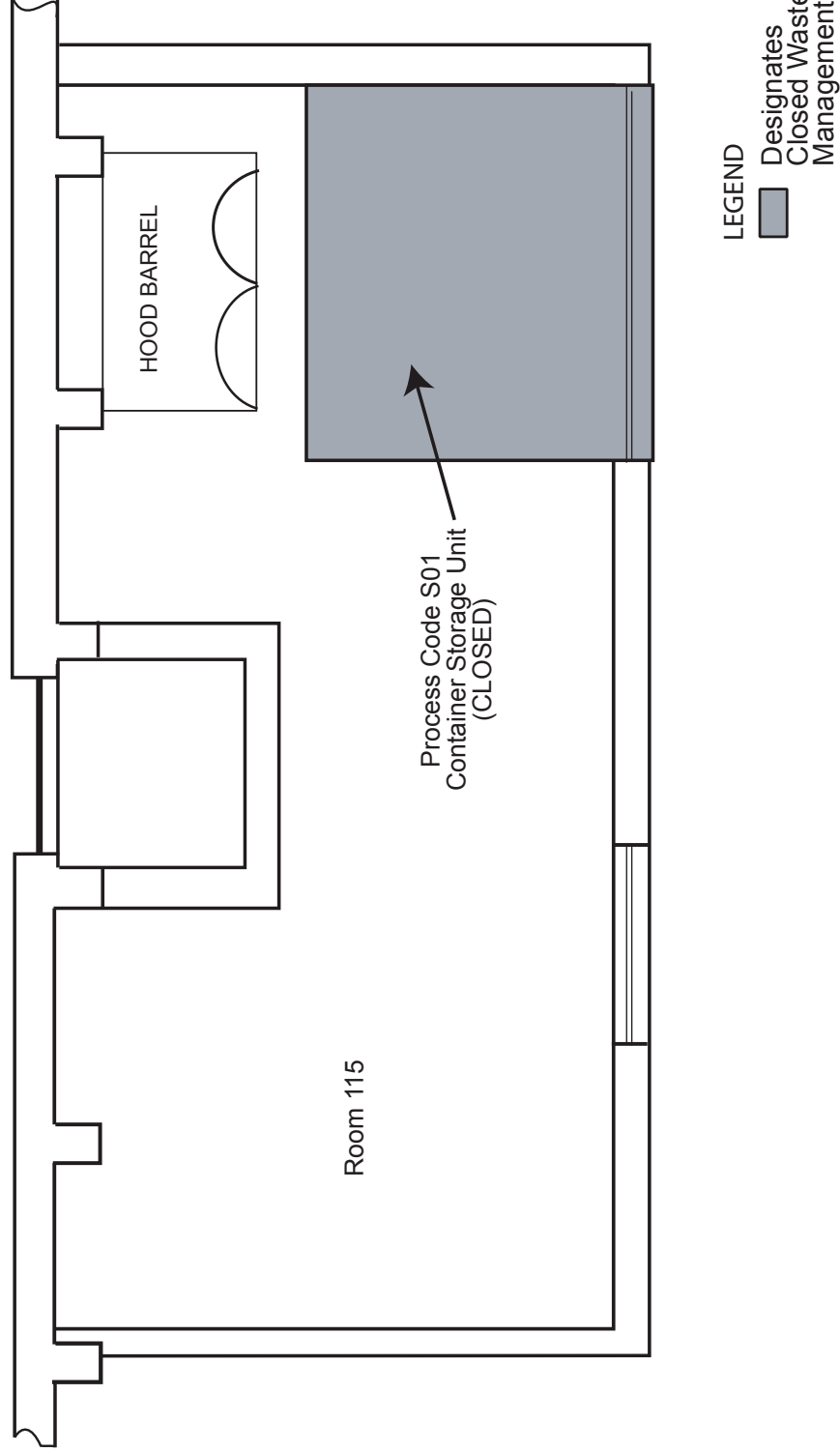
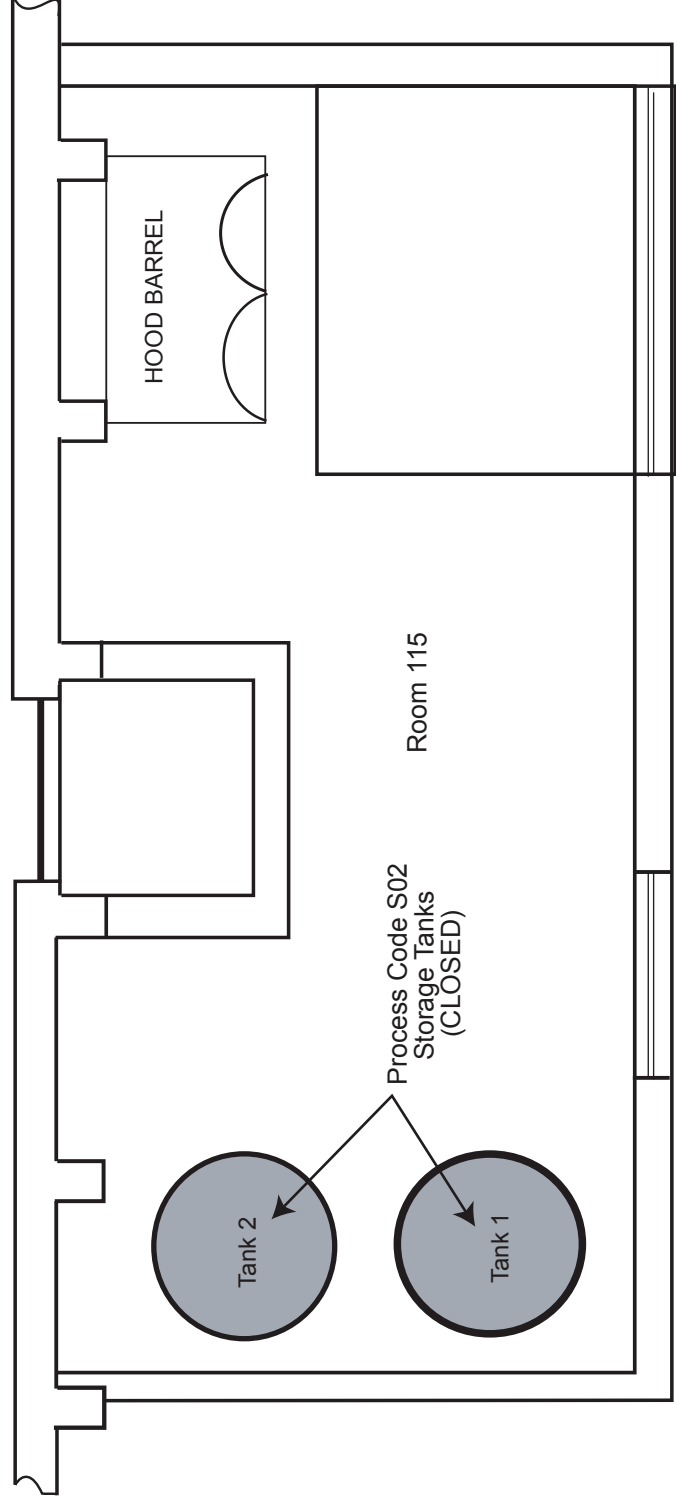

Figure 18
Technical Area (TA) 50, Building 37, Closed Container Storage Unit
(Associated with the Controlled Air Incinerator)



LEGEND
■ Designates Closed Waste Management Unit

Figure 19
Technical Area (TA) 50, Building 37, Storage Tanks Closed Under Interim Status



NOT TO SCALE

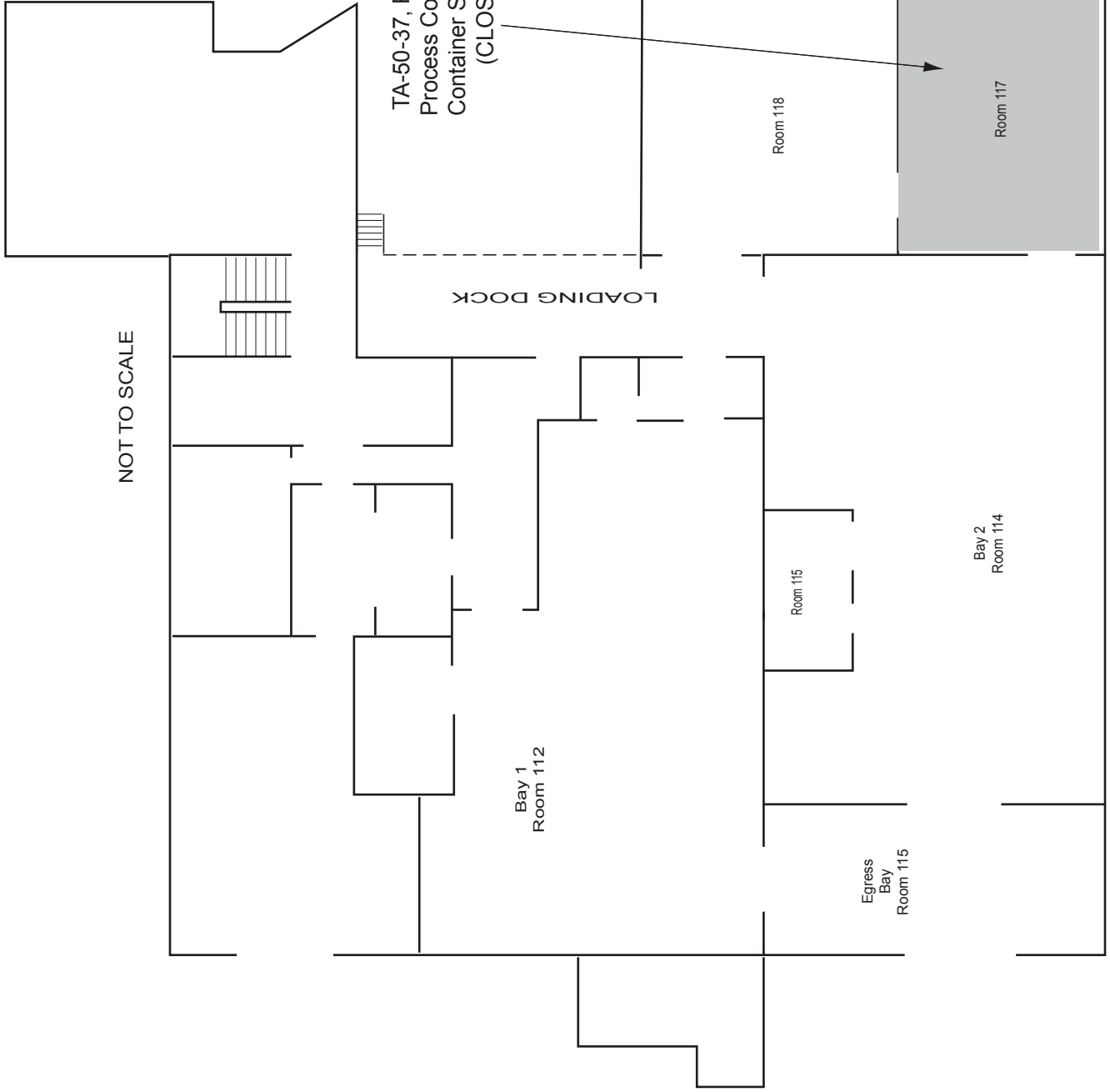

TA-50-37, Room 117
Process Code S01
Container Storage Unit
(CLOSED)

LEGEND
■ Designates
Closed Waste
Management Unit

Figure 20
Technical Area (TA) 50, Building 37, Room 117, Closed Container Storage Unit

NOT TO SCALE



TA-50-37, Rooms 115 and 118
Process Code S01
Container Storage Unit
(CLOSED)

LOADING DOCK

LEGEND



Designates Closed Waste Management Unit

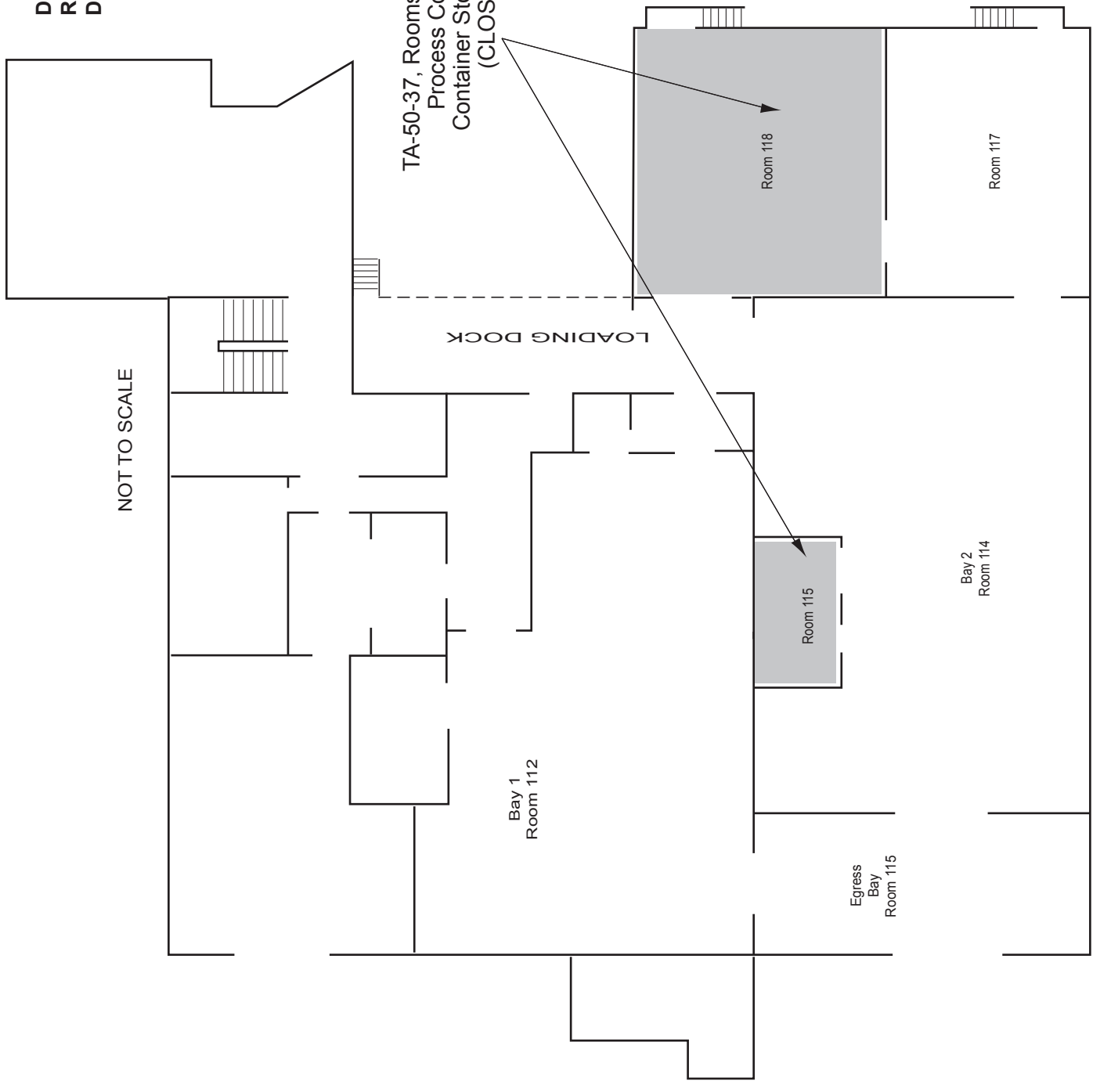
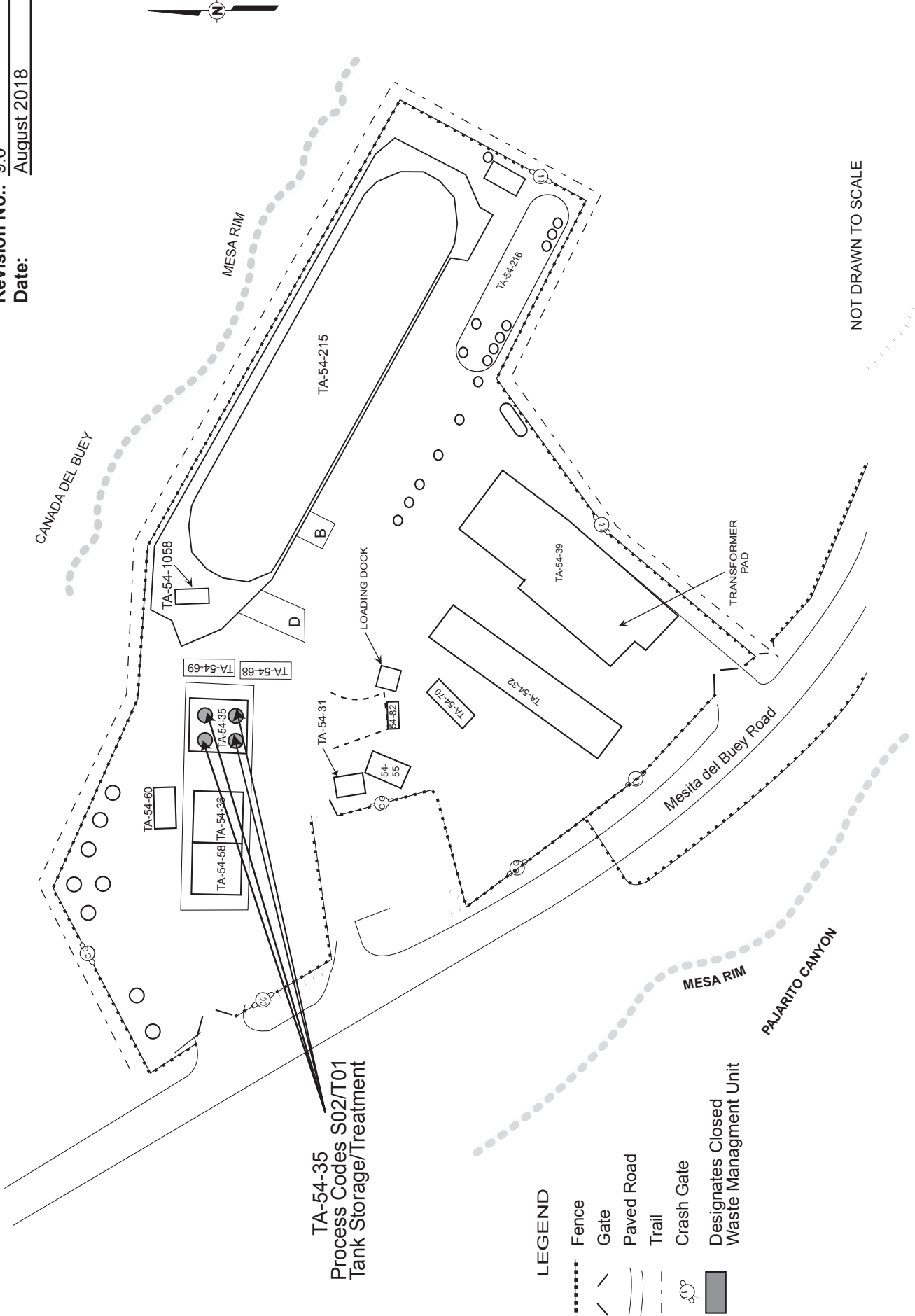

Figure 21
Technical Area (TA) 50, Building 37, Room 115 and 118, Container Storage Unit
Closed Under Interim Status



TA-54-35
 Process Codes S02/T01
 Tank Storage/Treatment

Figure 22
 Technical Area (TA) 54, Building 35, Area L, Closed Storage/Treatment Tanks

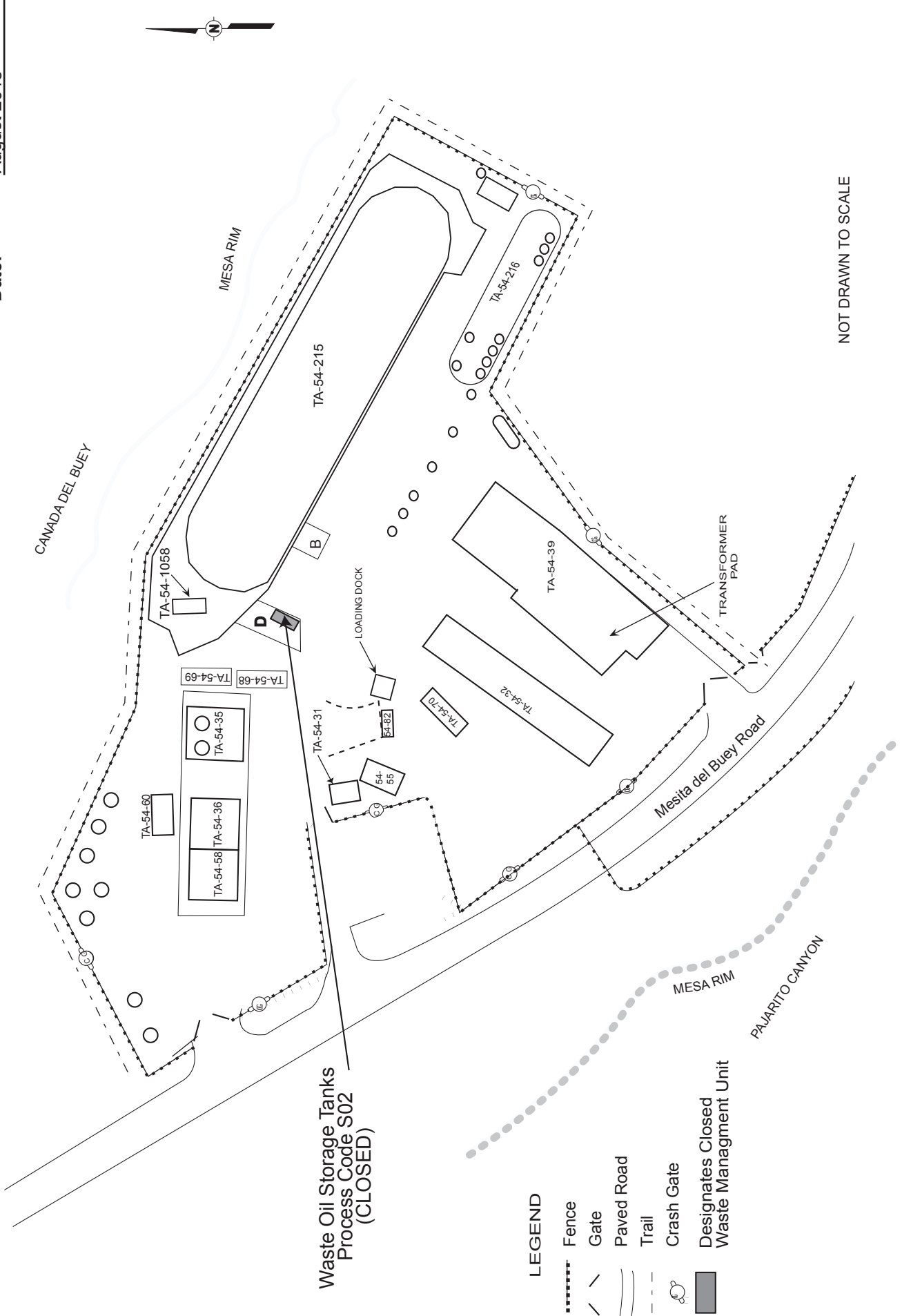

Figure 23
 Technical Area (TA) 54, Area L, Closed Waste Oil Storage Tanks

Figure 24

Technical Area (TA) 55, Building 4, Closed Oxygen Sparging Treatment Furnace

[This figure has been provided to the New Mexico Environment Department under separate cover as Unclassified Controlled Nuclear Information (UCNI) defined by Section 148 of the Atomic Energy Act.]

Figure 25

Technical Area (TA) 55, Building 4, Closed Container Storage Unit

[This figure has been provided to the New Mexico Environment Department under separate cover as Unclassified Controlled Nuclear Information (UCNI) defined by Section 148 of the Atomic Energy Act.]



Mortandad Canyon

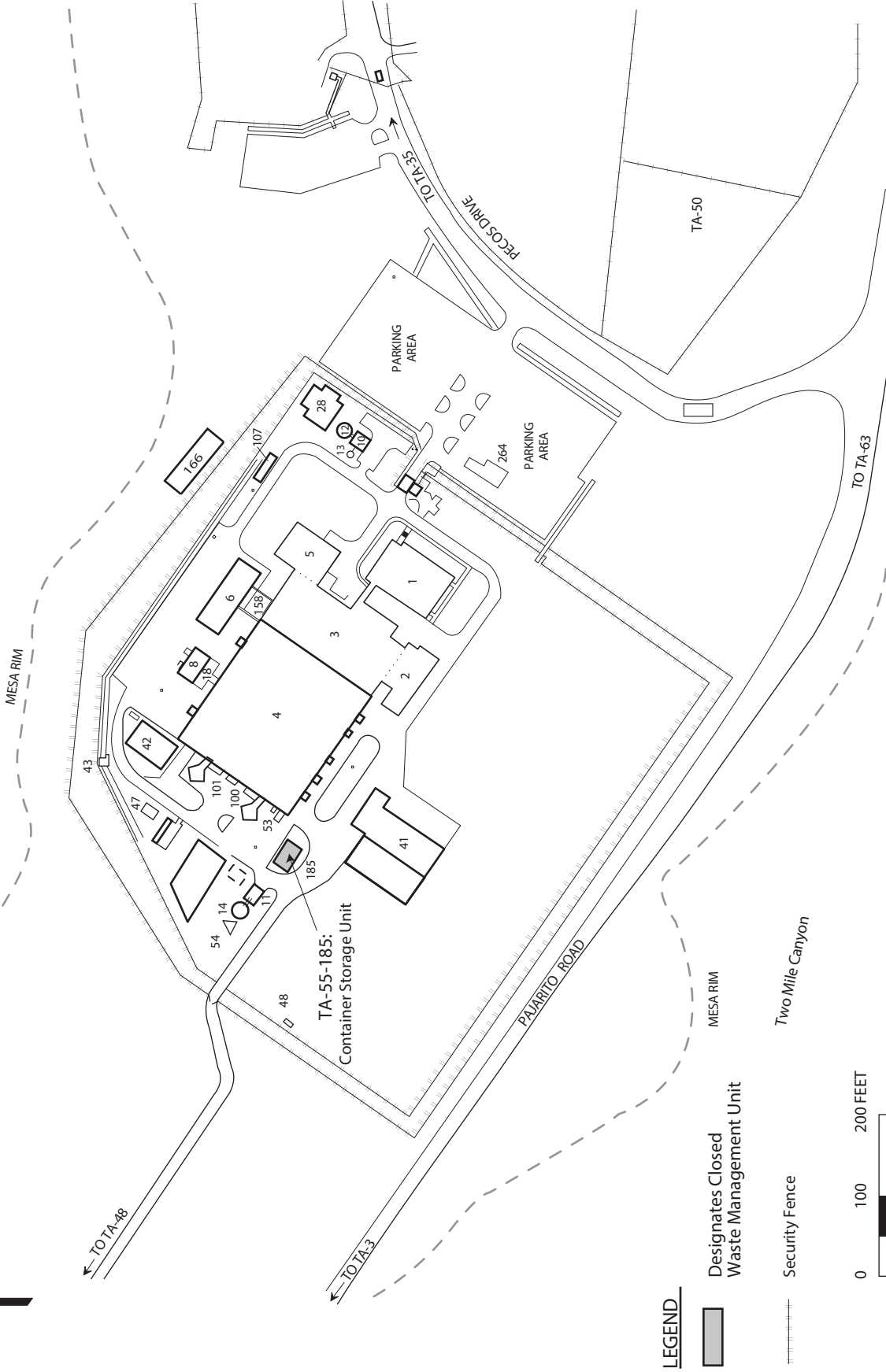

LEGEND

■ Designates Closed Waste Management Unit

--- Security Fence

0 100 200 FEET
 SCALE

Figure 26

Technical Area (TA) 55, Building 185, Administratively Closed Container Storage Unit