**Certification of Installation of
Enhanced Control Measures
at 2M-SMA-2**

LA-UR-13-22177

[This page intentionally blank.]

LOS ALAMOS NATIONAL LABORATORY
CERTIFICATION OF ENHANCED CONTROL MEASURES

PF: E012

2M-SMA-2

Sites: 03-050(d)
03-054(b)

The following certification was performed in accordance with NPDES Permit No. NM0030759, Part I.E.1 (c), which requires the Permittees (i.e. DOE and LANS) to certify the completion of the installation of control measures within 30 days of completion of the installation of all such measures at the site.

CERTIFICATION STATEMENT OF AUTHORIZATION

"I certify under penalty of law that this document and all attachments were prepared under my direction or supervision in accordance with a system designed to assure that qualified personnel properly gather and evaluate the information submitted. Based on my inquiry of the person or persons who manage the system, or those persons directly responsible for gathering the information, the information submitted is, to the best of my knowledge and belief, true, accurate and complete. I am aware there are significant penalties for submitting false information including the possibility of fine and imprisonment for knowing violations."

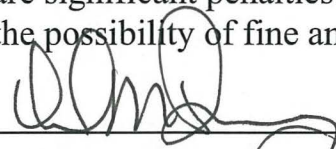

Environmental Programs
Corrective Actions Program
Los Alamos National Laboratory

5/2/2013

Date



Los Alamos Site Office
National Nuclear Security Administration

4-26-2013

Date

[This page intentionally blank.]

LOS ALAMOS NATIONAL LABORATORY
CERTIFICATION OF ENHANCED CONTROL MEASURES

PF: E012

2M-SMA-2

Sites: 03-050(d)
03-054(b)

In accordance with Part I.E.1 (a), the design, installation, and documentation of enhanced control measures reasonably expected to achieve compliance with target action levels identified in the Permit for all Sites within the identified SMA drainage area have been completed.

Enhanced Control Measure Description:			
BMP ID	Type of Control Measure	Control Measure	Photo ID
E01205020014	Sediment Traps and Basins	Sediment Basin	30364-1.JPG

LOS ALAMOS NATIONAL LABORATORY
CERTIFICATION OF ENHANCED CONTROL MEASURES

PF: E012

2M-SMA-2

Sites: 03-050(d)
03-054(b)

Photos:



Photo: 30364-1.JPG

E01205020014

Sediment Traps and Basins

- Sediment Basin

LOS ALAMOS NATIONAL LABORATORY
 CERTIFICATION OF ENHANCED CONTROL MEASURES REPORT
 2M-SMA-2

PF:E012

Sites: 03-050(d)
 03-054(b)

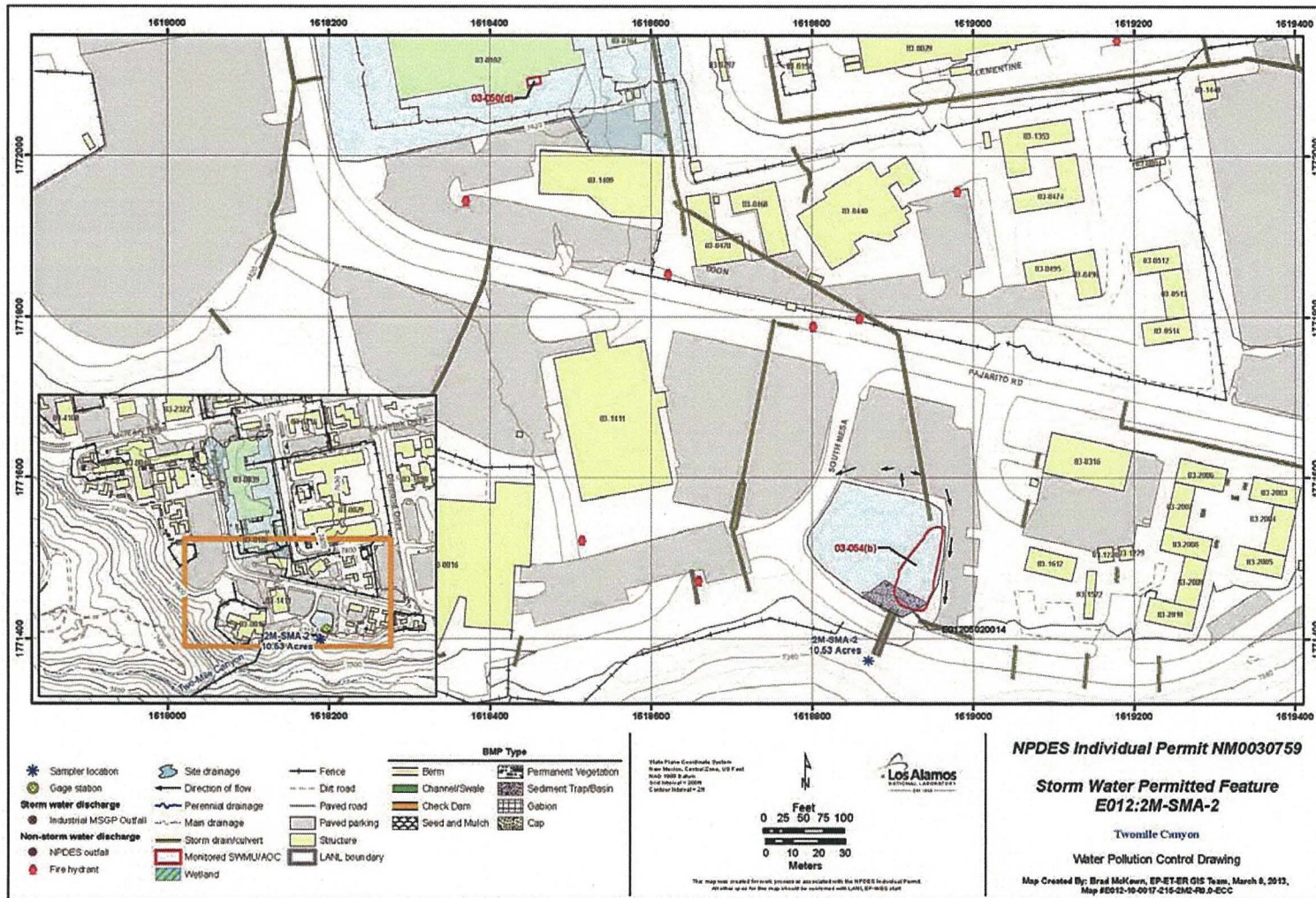



**Certification of Installation of
Enhanced Control Measures
at W-SMA-1**

LA-UR-13-22917

CONFIDENTIAL TO THE
OFFICE OF THE
ATTORNEY GENERAL

[This page intentionally blank.]

CONFIDENTIAL TO THE
OFFICE OF THE
ATTORNEY GENERAL

LOS ALAMOS NATIONAL LABORATORY
CERTIFICATION OF ENHANCED CONTROL MEASURES

PF: W001

W-SMA-1

Sites: 16-017(j)-99
16-026(c2)
16-026(v)

The following certification was performed in accordance with NPDES Permit No. NM0030759, Part I.E.1 (c), which requires the Permittees (i.e. DOE and LANS) to certify the completion of the installation of control measures within 30 days of completion of the installation of all such measures at the site.

CERTIFICATION STATEMENT OF AUTHORIZATION

"I certify under penalty of law that this document and all attachments were prepared under my direction or supervision in accordance with a system designed to assure that qualified personnel properly gather and evaluate the information submitted. Based on my inquiry of the person or persons who manage the system, or those persons directly responsible for gathering the information, the information submitted is, to the best of my knowledge and belief, true, accurate and complete. I am aware there are significant penalties for submitting false information including the possibility of fine and imprisonment for knowing violations."

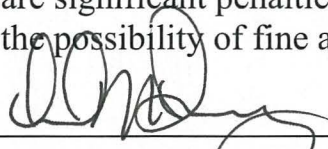

Environmental Programs
Corrective Actions Program
Los Alamos National Laboratory

5/2/2013

Date



Los Alamos Site Office
National Nuclear Security Administration

4-26-2013

Date

STATE OF TEXAS
COMMISSION ON THE JUDICIAL BRANCH

12-15-2010
12-15-2010
12-15-2010

12-15-2010

12-15-2010

The Commission on the Judicial Branch of the State of Texas is pleased to announce that it has received the following information regarding the proposed changes to the Texas Constitution...

PROPOSAL FOR A CHANGE TO THE CONSTITUTION

The Commission on the Judicial Branch of the State of Texas is pleased to announce that it has received the following information regarding the proposed changes to the Texas Constitution...

[This page intentionally blank.]

[Signature]

[Signature]

[Signature]

[Signature]

**LOS ALAMOS NATIONAL LABORATORY
CERTIFICATION OF ENHANCED CONTROL MEASURES**

PF: W001

W-SMA-1

Sites: 16-017(j)-99
16-026(c2)
16-026(v)

In accordance with Part I.E.1 (a), the design, installation, and documentation of enhanced control measures reasonably expected to achieve compliance with target action levels identified in the Permit for all Sites within the identified SMA drainage area have been completed.

Enhanced Control Measure Description:			
BMP ID	Type of Control Measure	Control Measure	Photo ID
W00103010014	Berms	Earthen Berm	30655-1.JPG
W00103010015	Berms	Earthen Berm	30655-3.JPG
W00104060017	Channel/Swale	Rip Rap	30655-7.JPG
W00105030016	Sediment Traps and Basins	Sand Filter	30655-4.JPG
W00106010012	Check Dam	Rock Check Dam	30655-1.JPG
W00106010013	Check Dam	Rock Check Dam	30655-5.JPG
W00108020018	Cap	Rock Cap	30655-8.JPG

LOS ALAMOS NATIONAL LABORATORY
CERTIFICATION OF ENHANCED CONTROL MEASURES

PF: W001

W-SMA-1

Sites: 16-017(j)-99
16-026(c2)
16-026(v)

Photos:



Photo: 30655-1.JPG

W00103010014 Berms

- Earthen Berm

W00106010012 Check Dam

- Rock Check Dam

LOS ALAMOS NATIONAL LABORATORY
CERTIFICATION OF ENHANCED CONTROL MEASURES

PF: W001

W-SMA-1

Sites: 16-017(j)-99
16-026(c2)
16-026(v)



Photo: 30655-3.JPG

W00103010015

Berms

- Earthen Berm

NPDES PERMIT NO. NM0030759

LA-UR-13-22917

LOS ALAMOS NATIONAL LABORATORY
CERTIFICATION OF ENHANCED CONTROL MEASURES

PF: W001

W-SMA-1

Sites: 16-017(j)-99
16-026(c2)
16-026(v)



Photo: 30655-4.JPG

W00105030016

Sediment Traps and Basins

- Sand Filter

NPDES PERMIT NO. NM0030759

LA-UR-13-22917

LOS ALAMOS NATIONAL LABORATORY
CERTIFICATION OF ENHANCED CONTROL MEASURES

PF: W001

W-SMA-1

Sites: 16-017(j)-99
16-026(c2)
16-026(v)



Photo: 30655-5.JPG

W00106010013 Check Dam

- Rock Check Dam

NPDES PERMIT NO. NM0030759

LA-UR-13-22917

LOS ALAMOS NATIONAL LABORATORY
CERTIFICATION OF ENHANCED CONTROL MEASURES

PF: W001

W-SMA-1

Sites: 16-017(j)-99
16-026(c2)
16-026(v)



Photo: 30655-7.JPG

W00104060017 Channel/Swale

Rip Rap

NPDES PERMIT NO. NM0030759

LA-UR-13-22917

LOS ALAMOS NATIONAL LABORATORY
CERTIFICATION OF ENHANCED CONTROL MEASURES

PF: W001

W-SMA-1

Sites: 16-017(j)-99
16-026(c2)
16-026(v)



Photo: 30655-8.JPG

W00108020018 Cap

- Rock Cap

LOS ALAMOS NATIONAL LABORATORY
CERTIFICATION OF ENHANCED CONTROL MEASURES REPORT
W-SMA-1

PF:W001

Sites: 16-017(j)-99
16-026(c2)
16-026(v)

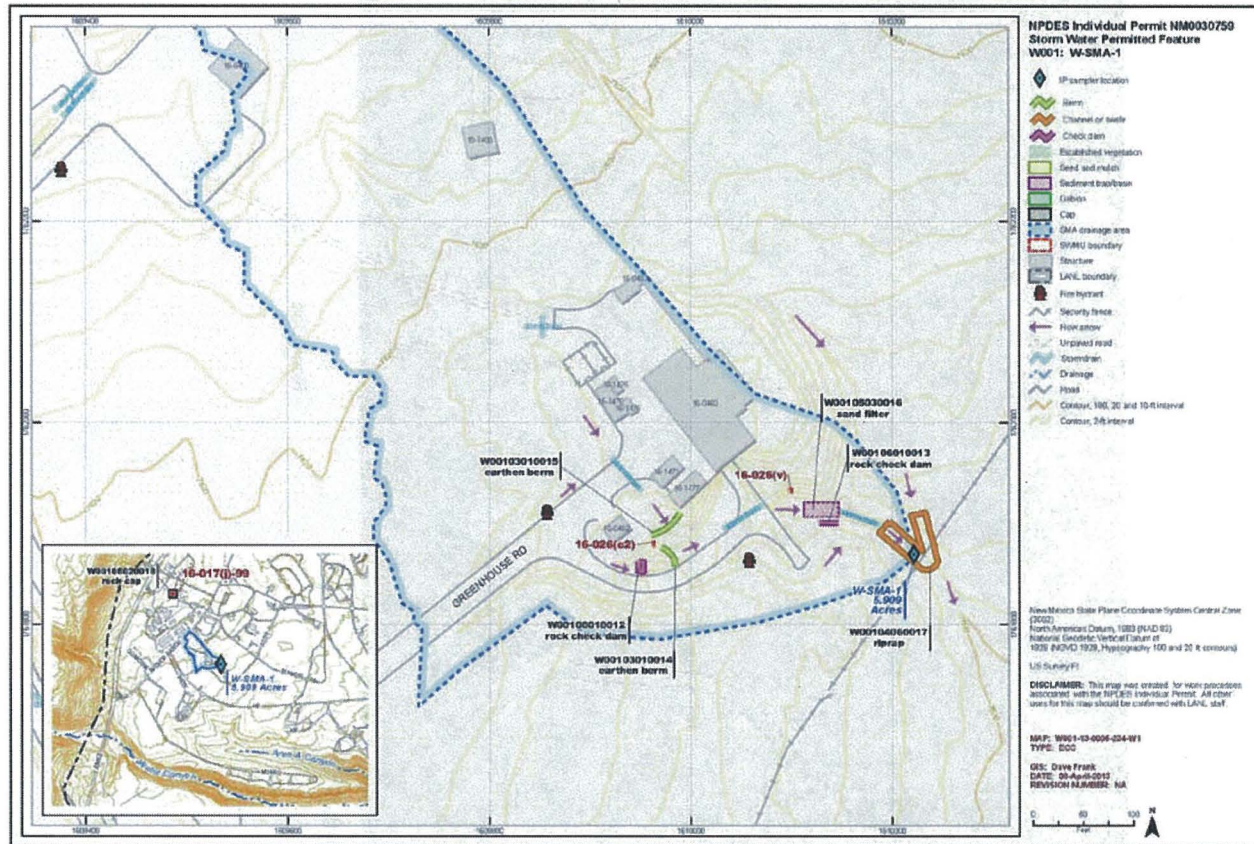

**Certification of Installation of
Enhanced Control Measures
at STRM-SMA-1.05**

LA-UR-13-22866

Continuation of Schedule D
Form 1041-99-41

[This page intentionally blank.]

1041-99-41

LOS ALAMOS NATIONAL LABORATORY
CERTIFICATION OF ENHANCED CONTROL MEASURES

PF: J028

STRM-SMA-1.05

Sites: 08-009(f)

The following certification was performed in accordance with NPDES Permit No. NM0030759, Part I.E.1 (c), which requires the Permittees (i.e. DOE and LANS) to certify the completion of the installation of control measures within 30 days of completion of the installation of all such measures at the site.

CERTIFICATION STATEMENT OF AUTHORIZATION

"I certify under penalty of law that this document and all attachments were prepared under my direction or supervision in accordance with a system designed to assure that qualified personnel properly gather and evaluate the information submitted. Based on my inquiry of the person or persons who manage the system, or those persons directly responsible for gathering the information, the information submitted is, to the best of my knowledge and belief, true, accurate and complete. I am aware there are significant penalties for submitting false information including the possibility of fine and imprisonment for knowing violations."

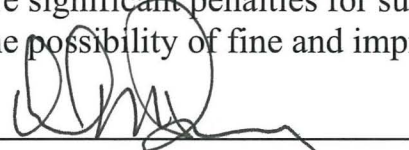
Environmental Programs
Corrective Actions Program
Los Alamos National Laboratory

5/2/2013
Date

Los Alamos Site Office
National Nuclear Security Administration

4-26-2013
Date

STATE OF TEXAS
COUNTY OF DALLAS

10/10/2013

10/10/2013

10/10/2013

THIS INSTRUMENT IS A TRUE AND CORRECT COPY OF THE ORIGINAL INSTRUMENT AS FILED IN THE PUBLIC RECORDS OF THE COUNTY OF DALLAS, TEXAS, ON 10/10/2013 AT 10:10 AM. THE INSTRUMENT IS IDENTIFIED BY THE FOLLOWING INFORMATION:

STATE OF TEXAS
COUNTY OF DALLAS

THIS INSTRUMENT IS A TRUE AND CORRECT COPY OF THE ORIGINAL INSTRUMENT AS FILED IN THE PUBLIC RECORDS OF THE COUNTY OF DALLAS, TEXAS, ON 10/10/2013 AT 10:10 AM. THE INSTRUMENT IS IDENTIFIED BY THE FOLLOWING INFORMATION:

[This page intentionally blank.]

10/10/2013

[Signature]
Notary Public
State of Texas

[Signature]

[Signature]
Notary Public
State of Texas

LOS ALAMOS NATIONAL LABORATORY
 CERTIFICATION OF ENHANCED CONTROL MEASURES

PF: J028

STRM-SMA-1.05

Sites: 08-009(f)

In accordance with Part I.E.1 (a), the design, installation, and documentation of enhanced control measures reasonably expected to achieve compliance with target action levels identified in the Permit for all Sites within the identified SMA drainage area have been completed.

Enhanced Control Measure Description:			
BMP ID	Type of Control Measure	Control Measure	Photo ID
J02808030008	Cap	Concrete/Asphalt Cap	30475-1.JPG

NPDES PERMIT NO. NM0030759

LA-UR-13-22866

LOS ALAMOS NATIONAL LABORATORY
CERTIFICATION OF ENHANCED CONTROL MEASURES

PF: J028

STRM-SMA-1.05

Sites: 08-009(f)

Photos:



Photo: 30475-1.JPG

J02808030008 Cap

- Concrete/Asphalt Cap

LOS ALAMOS NATIONAL LABORATORY
CERTIFICATION OF ENHANCED CONTROL MEASURES REPORT
STRM-SMA-1.05

PF:J028

Sites: 08-009(f)

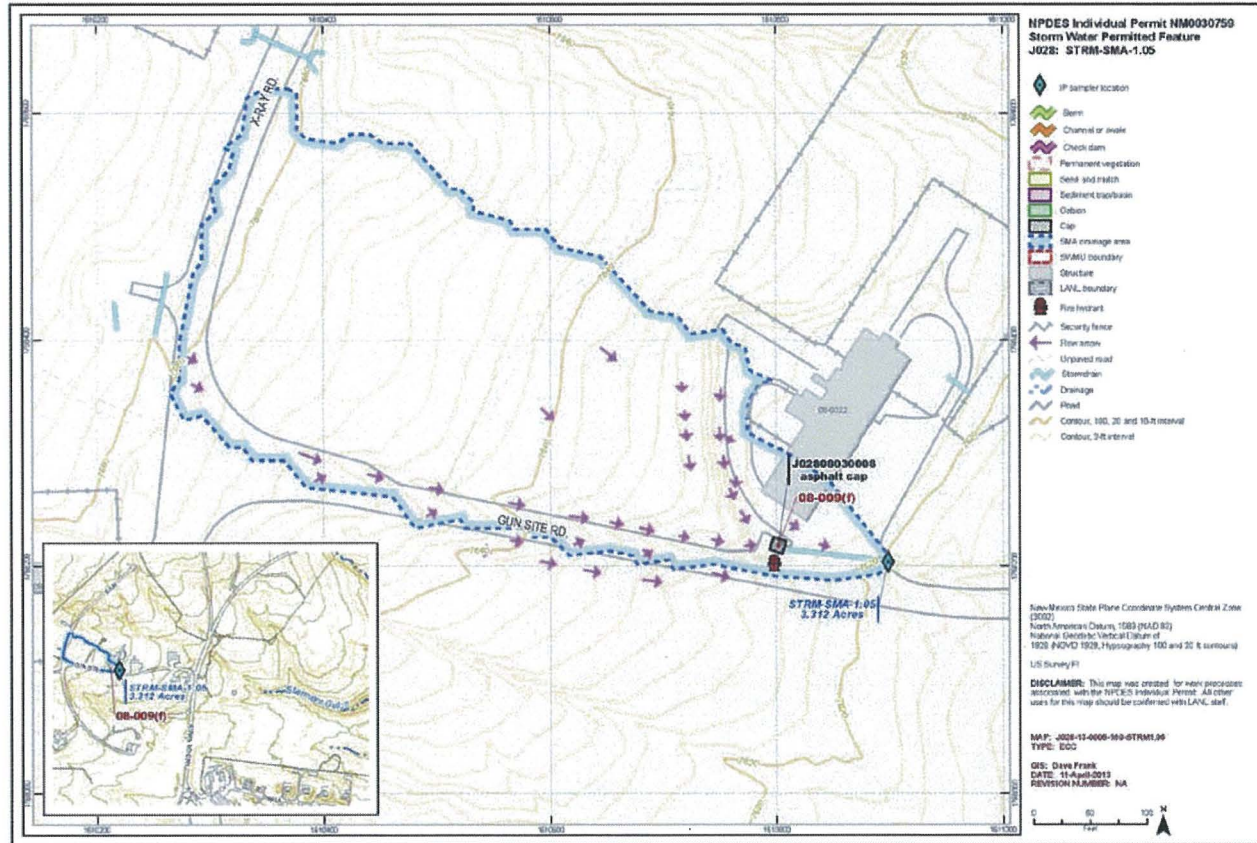



**Certification of Installation of
Enhanced Control Measures
at S-SMA-3.53**

LA-UR-13-22188

[This page intentionally blank.]

LOS ALAMOS NATIONAL LABORATORY
CERTIFICATION OF ENHANCED CONTROL MEASURES

PF: S005B

S-SMA-3.53

Sites: 03-014
(b2)

The following certification was performed in accordance with NPDES Permit No. NM0030759, Part I.E.1 (c), which requires the Permittees (i.e. DOE and LANS) to certify the completion of the installation of control measures within 30 days of completion of the installation of all such measures at the site.

CERTIFICATION STATEMENT OF AUTHORIZATION

"I certify under penalty of law that this document and all attachments were prepared under my direction or supervision in accordance with a system designed to assure that qualified personnel properly gather and evaluate the information submitted. Based on my inquiry of the person or persons who manage the system, or those persons directly responsible for gathering the information, the information submitted is, to the best of my knowledge and belief, true, accurate and complete. I am aware there are significant penalties for submitting false information including the possibility of fine and imprisonment for knowing violations."

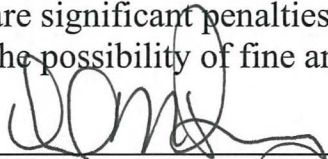

Environmental Programs
Corrective Actions Program
Los Alamos National Laboratory

5/2/2013

Date



Los Alamos Site Office
National Nuclear Security Administration

4-26-2013

Date

NOTIFICATION OF INTEREST FOR APPLICATION

[This page intentionally blank.]

2/25/12



2/25/12



**LOS ALAMOS NATIONAL LABORATORY
CERTIFICATION OF ENHANCED CONTROL MEASURES**

PF: S005B

S-SMA-3.53

Sites: 03-014
(b2)

In accordance with Part I.E.1 (a), the design, installation, and documentation of enhanced control measures reasonably expected to achieve compliance with target action levels identified in the Permit for all Sites within the identified SMA drainage area have been completed.

Enhanced Control Measure Description:			
BMP ID	Type of Control Measure	Control Measure	Photo ID
S005B04040007	Channel/Swale	Culvert	30405-1.JPG
S005B04060006	Channel/Swale	Rip Rap	30405-1.JPG
S005B08030008	Cap	Concrete/Asphalt Cap	30405-5.JPG

LOS ALAMOS NATIONAL LABORATORY
CERTIFICATION OF ENHANCED CONTROL MEASURES

PF: S005B

S-SMA-3.53

Sites: 03-014
(b2)

Photos:



Photo: 30405-1.JPG

S005B04040007 Channel/Swale

- Culvert

S005B04060006 Channel/Swale

- Rip Rap

LOS ALAMOS NATIONAL LABORATORY
CERTIFICATION OF ENHANCED CONTROL MEASURES

PF: S005B

S-SMA-3.53

Sites: 03-014
(b2)



Photo: 30405-5.JPG
S005B08030008 Cap

- Concrete/Asphalt Cap

LOS ALAMOS NATIONAL LABORATORY
 CERTIFICATION OF ENHANCED CONTROL MEASURES REPORT
 S-SMA-3.53

PF:S005B

Sites: 03-014(b2)

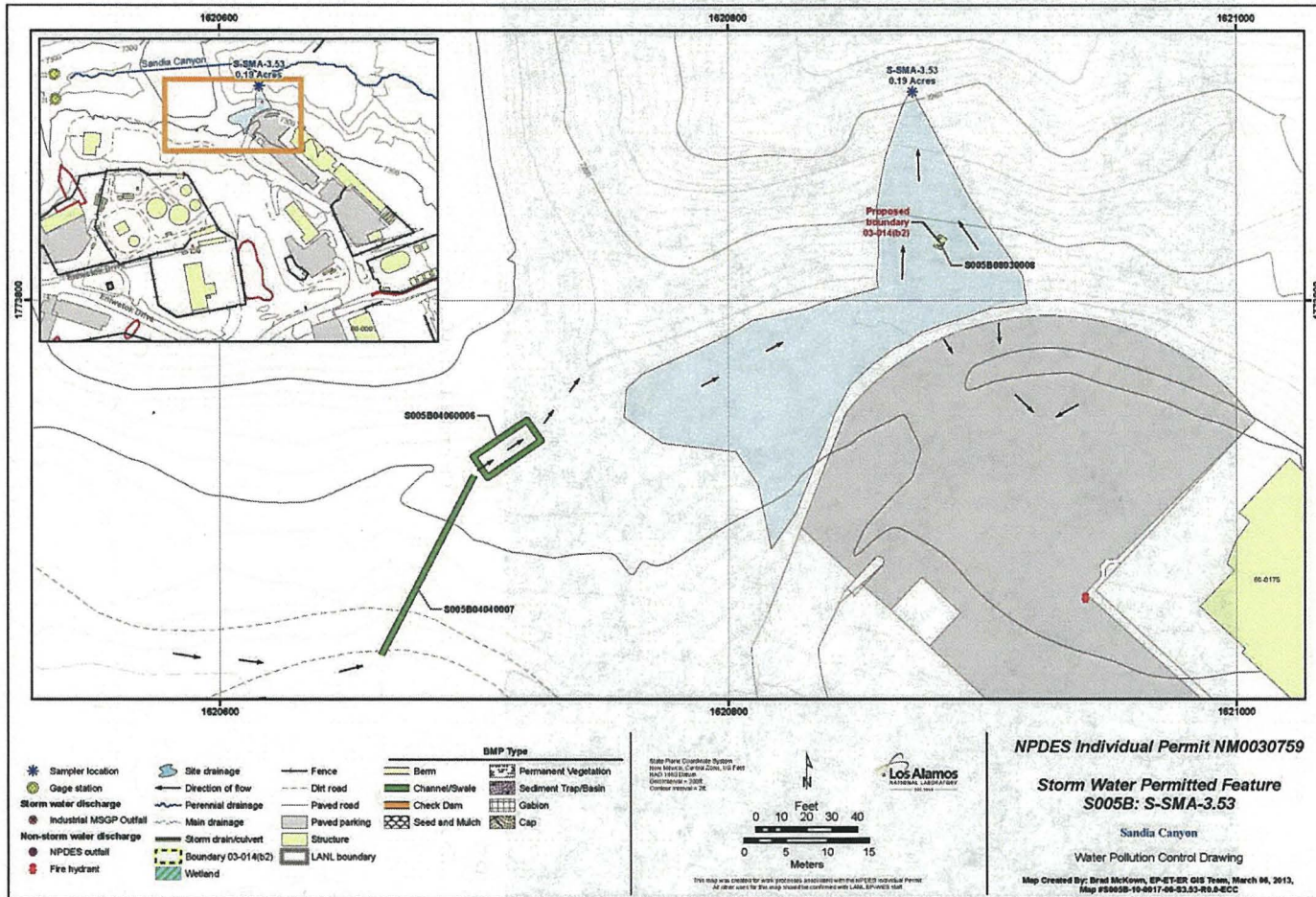

**Certification of Installation of
Enhanced Control Measures
at M-SMA-1.22**

LA-UR-13-22199

[This page intentionally blank.]

LOS ALAMOS NATIONAL LABORATORY
CERTIFICATION OF ENHANCED CONTROL MEASURES

PF: M002B

M-SMA-1.22

Sites: 03-045(h)

The following certification was performed in accordance with NPDES Permit No. NM0030759, Part I.E.1 (c), which requires the Permittees (i.e. DOE and LANS) to certify the completion of the installation of control measures within 30 days of completion of the installation of all such measures at the site.

CERTIFICATION STATEMENT OF AUTHORIZATION

"I certify under penalty of law that this document and all attachments were prepared under my direction or supervision in accordance with a system designed to assure that qualified personnel properly gather and evaluate the information submitted. Based on my inquiry of the person or persons who manage the system, or those persons directly responsible for gathering the information, the information submitted is, to the best of my knowledge and belief, true, accurate and complete. I am aware there are significant penalties for submitting false information including the possibility of fine and imprisonment for knowing violations."

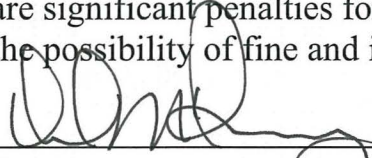
Environmental Programs
Corrective Actions Program
Los Alamos National Laboratory

5/2/2013
Date

Los Alamos Site Office
National Nuclear Security Administration

4-26-2013
Date

[This page intentionally blank.]

LOS ALAMOS NATIONAL LABORATORY
CERTIFICATION OF ENHANCED CONTROL MEASURES

PF: M002B

M-SMA-1.22

Sites: 03-045(h)

In accordance with Part I.E.1 (a), the design, installation, and documentation of enhanced control measures reasonably expected to achieve compliance with target action levels identified in the Permit for all Sites within the identified SMA drainage area have been completed.

Enhanced Control Measure Description:			
BMP ID	Type of Control Measure	Control Measure	Photo ID
M002B03010010	Berms	Earthen Berm	30577-6.JPG
M002B03010011	Berms	Earthen Berm	30577-5.JPG
M002B03010012	Berms	Earthen Berm	30577-1.JPG
M002B05030013	Sediment Traps and Basins	Sand Filter	30577-2.JPG

LOS ALAMOS NATIONAL LABORATORY
CERTIFICATION OF ENHANCED CONTROL MEASURES

PF: M002B

M-SMA-1.22

Sites: 03-045(h)

Photos:



Photo: 30577-1.JPG
M002B03010012 Berms

- Earthen Berm

NPDES PERMIT NO. NM0030759

LA-UR-13-22199

LOS ALAMOS NATIONAL LABORATORY
CERTIFICATION OF ENHANCED CONTROL MEASURES

PF: M002B

M-SMA-1.22

Sites: 03-045(h)



Photo: 30577-2.JPG

M002B05030013

Sediment Traps and Basins

- Sand Filter

NPDES PERMIT NO. NM0030759

LA-UR-13-22199

LOS ALAMOS NATIONAL LABORATORY
CERTIFICATION OF ENHANCED CONTROL MEASURES

PF: M002B

M-SMA-1.22

Sites: 03-045(h)



Photo: 30577-5.JPG
M002B03010011 Berms

- Earthen Berm

LOS ALAMOS NATIONAL LABORATORY
CERTIFICATION OF ENHANCED CONTROL MEASURES

PF: M002B

M-SMA-1.22

Sites: 03-045(h)



Photo: 30577-6.JPG

M002B03010010 Berms

- Earthen Berm

LOS ALAMOS NATIONAL LABORATORY
 CERTIFICATION OF ENHANCED CONTROL MEASURES REPORT
 M-SMA-1.22

PF:M002B

Sites: 03-045(h)

